

Product Ver: 24.2a (LMS Tech)
 File: P:\BECPC PROJECTS\3709 Brookfield Properties\09-004 Suffern NY.Dwg (Exhibits Misc) 2023-05-30 Temp_SCD\370909004SE3.dwg. ---> 01 EROSION AND STORMWATER POLLUTION PREVENTION PLAN
 Plotted: 05/30/23 - 1:04 PM, By: gowdrick,
 FOR STATE OFFICIALS DIRECT PHONE NUMBERS VISIT: WWW.CALL811.COM

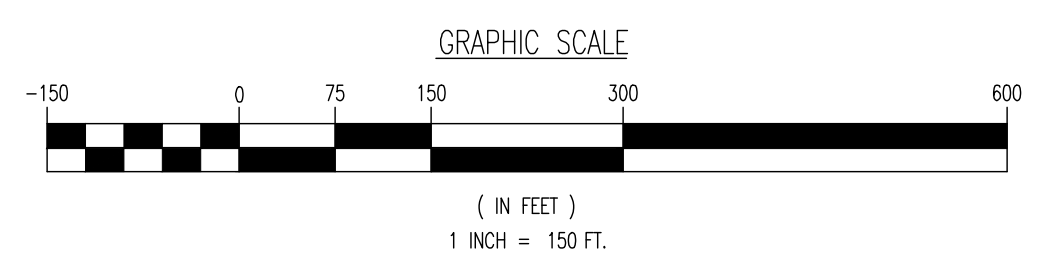
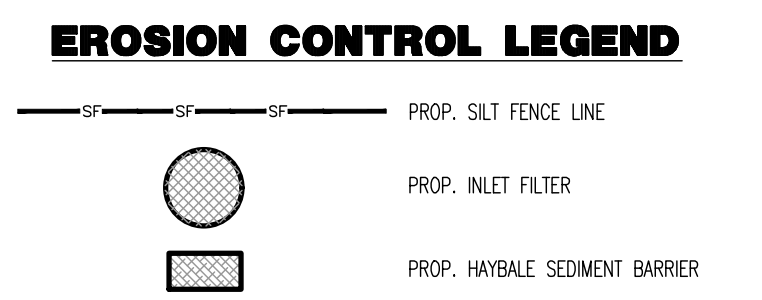
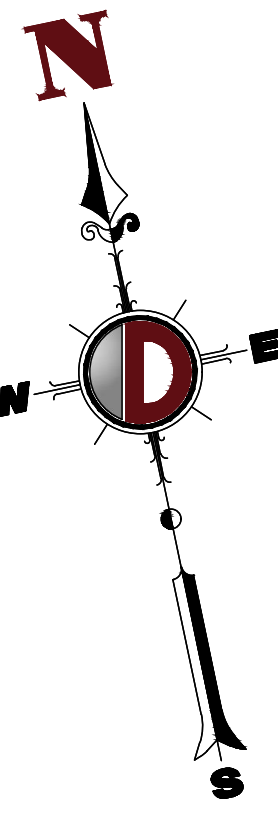
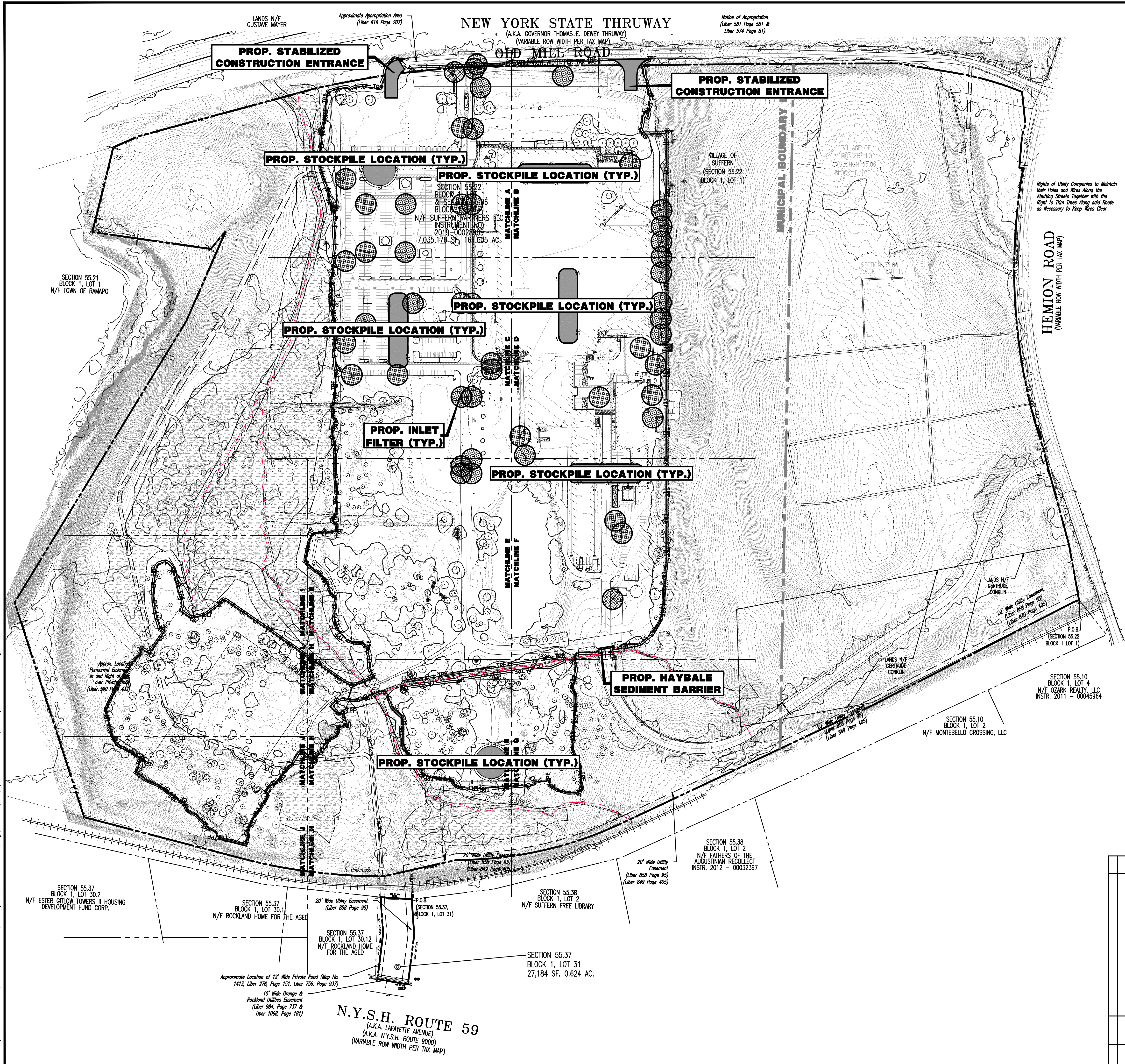

THIS PLAN SET IS FOR PERMITTING PURPOSES ONLY AND MAY NOT BE USED FOR CONSTRUCTION

DYNAMIC ENGINEERING
 LAND DEVELOPMENT CONSULTING • PERMITTING • GEOTECHNICAL • ENVIRONMENTAL • SURVEY • PLANNING & ZONING

1964 Main Street
 Lake Carme, NJ 07719
 T: 732.974.0198
 F: 732.974.5521
 www.dynamiceng.com

TITLE:
EROSION AND STORMWATER POLLUTION PREVENTION PLAN

PROJECT: **IV2 ROCKLAND LOGISTICS, LLC
 PROPOSED INDUSTRIAL PARK AT 25 OLD MILL ROAD**
 SECTION 55.22 BLOCK 1, LOT 1; SECTION 55.37; BLOCK 1, LOT 31
 OLD MILL ROAD AND HEMION ROAD (CR 93)
 VILLAGE OF SUFFERN, ROCKLAND COUNTY, NEW YORK

JOB No: 3709-99-004 DATE: 05/30/2023
 DRAWN BY: GMC SCALE: (H) 1"=150'
 DESIGNED BY: JMS (V)
 CHECKED BY: JMS SHEET No:
 CHECKED BY: -

JOHN A. PALUS **JOSHUA M. SEWALD**

PROFESSIONAL ENGINEER NEW YORK LICENSE No. 087502
 PROFESSIONAL ENGINEER NEW YORK LICENSE No. 097639

811 PROTECT YOURSELF
 ALL UTILITIES REQUIRE NOTIFICATION OF
 EXCAVATION WORKERS. IF YOU ARE
 PREPARING TO EXCAVATE OR DIG,
 PLEASE CALL 811 AT LEAST 3 BUSINESS
 DAYS BEFORE YOU START.
 FOR STATE OFFICIALS DIRECT PHONE NUMBERS VISIT:
 WWW.CALL811.COM

Rev. # 0

Approximate Appropriation Area (Liber 616 Page 207)

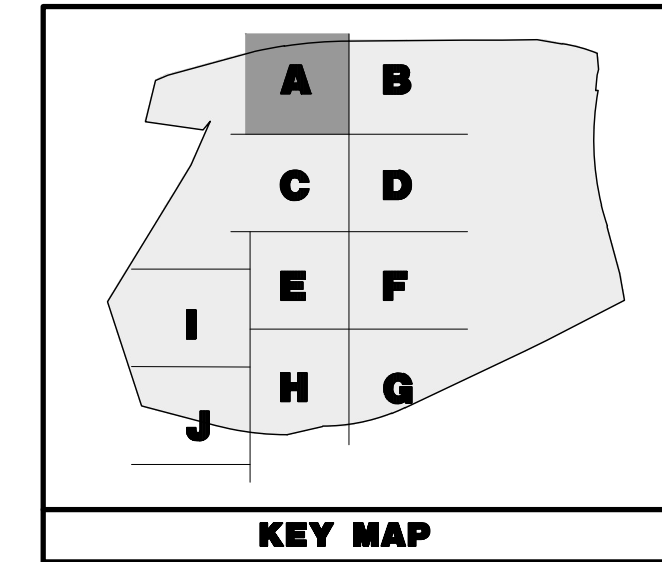
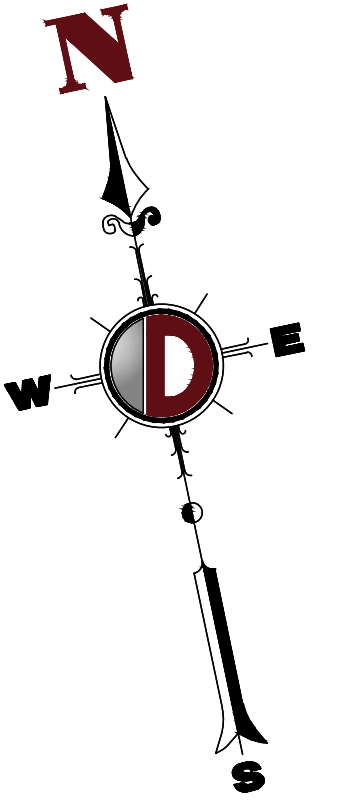

EROSION CONTROL LEGEND

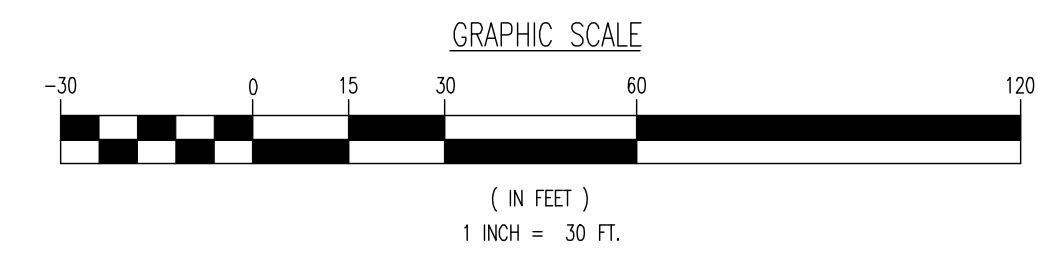
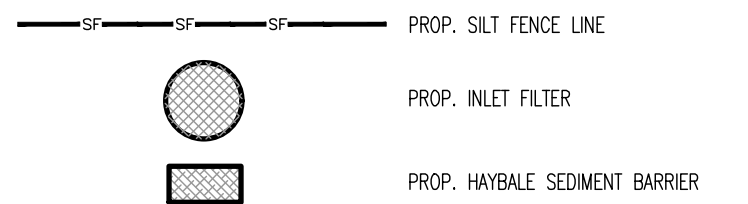

PROP. STABILIZED CONSTRUCTION ENTRANCE
PROP. TREE PROTECTION FENCE
PROP. SILT FENCE

PROP. STOCKPILE LOCATION (TYP.)

PROP. INLET FILTER (TYP.)

PROP. SILT FENCE

PROP. TREE PROTECTION FENCE

MATCHLINE A
MATCHLINE B

MATCHLINE A
MATCHLINE C
MATCHLINE B
MATCHLINE D

Plotted: 05/30/23 - 1:04 PM, By: gowdrick, Product Ver: 24.2e (LMS Tech)
File: P:\VEPC PROJECTS\3709 Brookfield Properties\09-004 Sufferin NY.Dwg (Exhibits (Misc)) 2023-05-30 Temp SCD\370909004SE3.dwg. ---> 02 EROSION AND STORMWATER POLLUTION PREVENTION PLAN A

THIS PLAN SET IS FOR PERMITTING PURPOSES ONLY AND MAY NOT BE USED FOR CONSTRUCTION

DYNAMIC ENGINEERING
LAND DEVELOPMENT CONSULTING • PERMITTING • GEO TECHNICAL • ENVIRONMENTAL • SURVEY • PLANNING & ZONING

1964 Main Street
Lake Como, NJ 07719
T: 732.974.0198
F: 732.974.3521
www.dynamiceng.com

State of New Jersey
Luka Coma, New Jersey T: 732.974.0198 | Chester, New Jersey T: 908.879.9229 | Newark, New Jersey T: 973.255.7200 | Torus River, New Jersey T: 732.478.0000
Allen, Texas T: 972.334.2100 | Austin, Texas T: 512.244.2444 | Houston, Texas T: 281.789.4400 | Detroit Beach, North Carolina T: 843.921.0510
Newtown, Pennsylvania T: 267.685.0276 | Philadelphia, Pennsylvania T: 215.253.4888 | Bethlehem, Pennsylvania T: 610.978.4400

TITLE:
EROSION AND STORMWATER POLLUTION PREVENTION PLAN A

PROJECT: **IV2 ROCKLAND LOGISTICS, LLC
PROPOSED INDUSTRIAL PARK AT 25 OLD MILL ROAD**
SECTION 55.22 BLOCK 1, LOT 1; SECTION 55.37; BLOCK 1, LOT 31
OLD MILL ROAD AND HEMION ROAD (CR 93)
VILLAGE OF SUFFERN, ROCKLAND COUNTY, NEW YORK

JOB No: 3709-99-004 DATE: 05/30/2023
DRAWN BY: GMC SCALE: (H) 1"=30'
(V)
DESIGNED BY: JMS SHEET No:
CHECKED BY: JMS
BY: _____

JOHN A. PALUS **JOSHUA M. SEWALD**

PROFESSIONAL ENGINEER NEW YORK LICENSE No. 087502
PROFESSIONAL ENGINEER NEW YORK LICENSE No. 097639

811 PROTECT YOURSELF
ALL UTILITIES SHOULD BE LOCATED BY
ELECTRIC, GAS, WATER, OR ANY OTHER
UTILITY BEFORE ANY EXCAVATION
OR DRILLING IS PERFORMED TO AVOID
DAMAGE TO UTILITIES AND INJURY
OR DEATH TO PERSONS.
FOR STATE SPECIFICATIONS VISIT:
WWW.CALL811.COM

Rev. # 0

Plotted: 05/30/23 - 1:05 PM, By: gowdrick, Product Ver: 24.2e (LMS Tech)
 File: P:\VEPC PROJECTS\3709 Brookfield Properties\09-004 Suffern NY.Dwg (Exhibits Misc) 2023-05-30 Temp SCD\370909004SE3.dwg. ---> 04 EROSION AND STORMWATER POLLUTION PREVENTION PLAN C

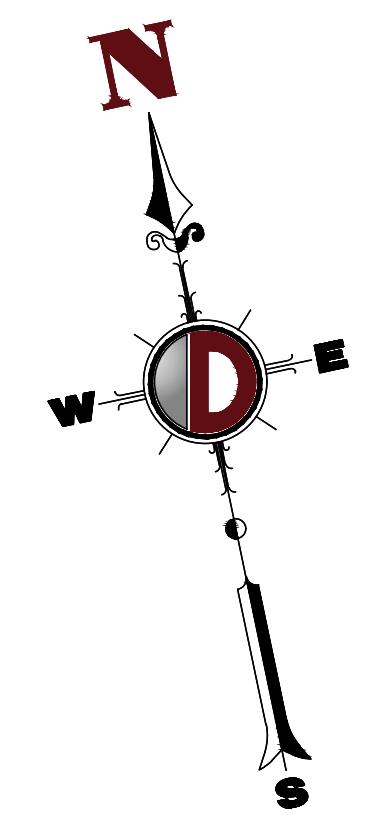
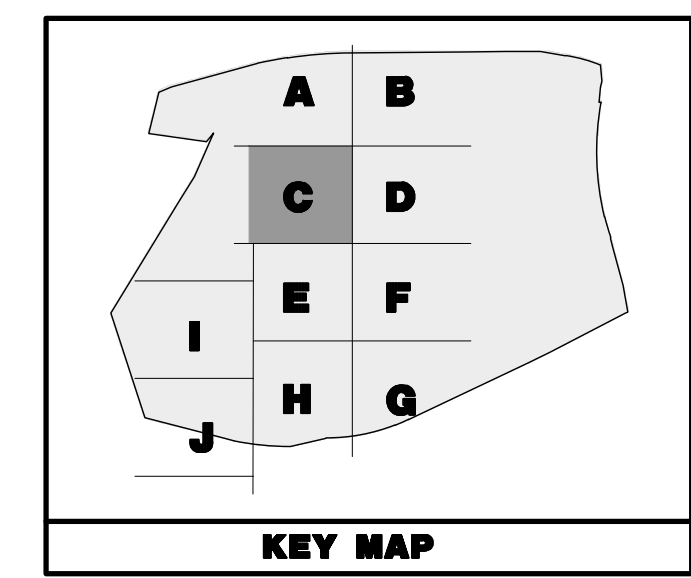
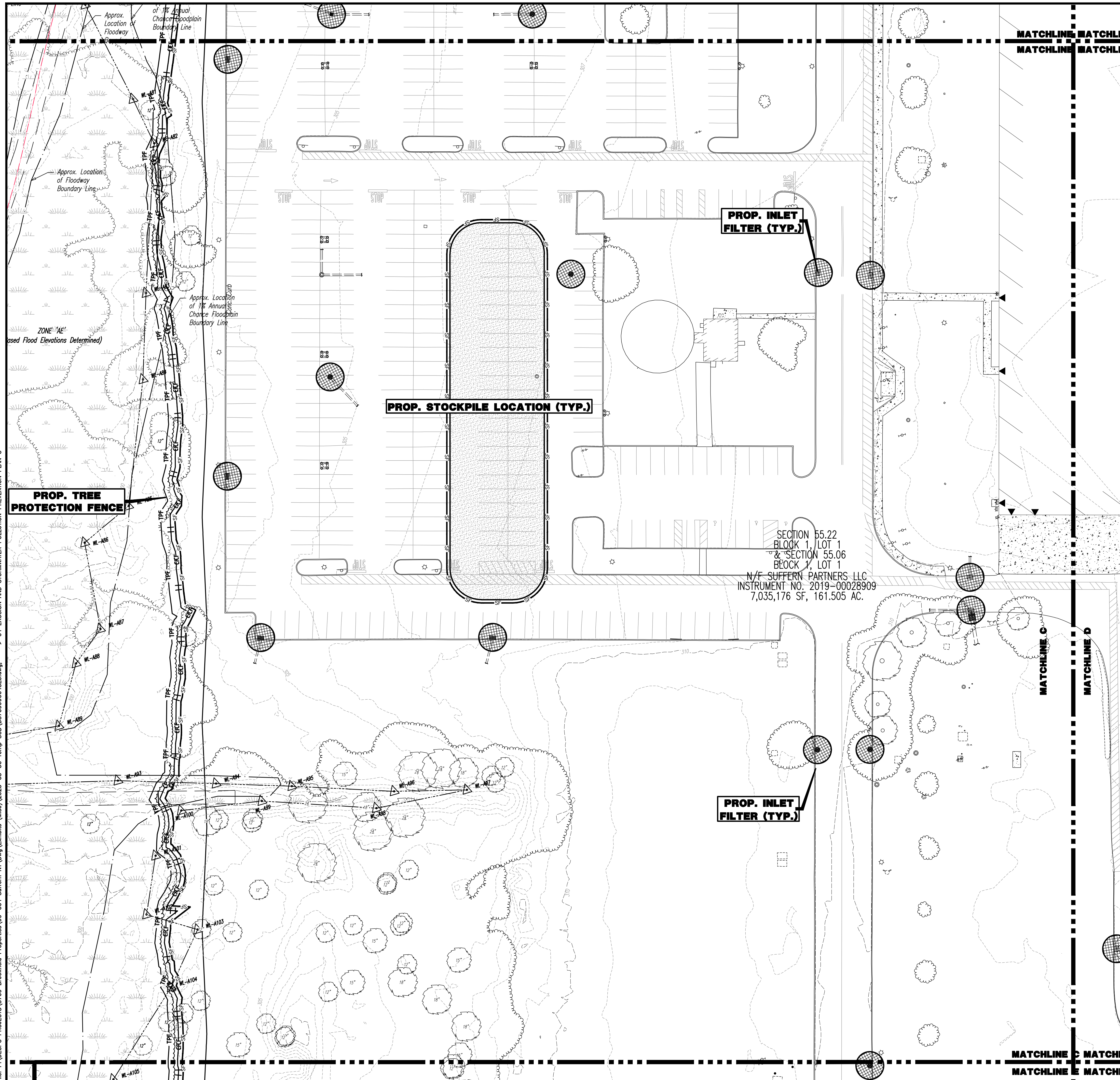

EROSION CONTROL LEGEND

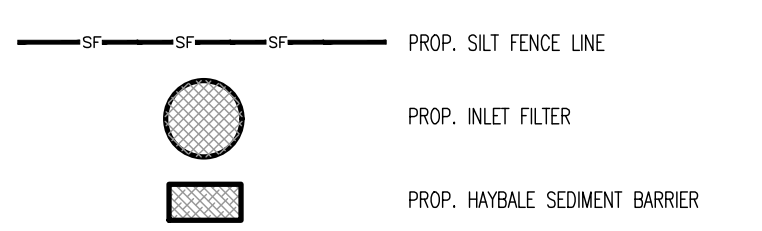

SECTION 55.22
 BLOCK 1, LOT 1
 & SECTION 55.06
 BLOCK 1, LOT 1
 N/F SUFFERN PARTNERS LLC
 INSTRUMENT NO. 2019-00028909
 7,035,176 SF, 161.505 AC.

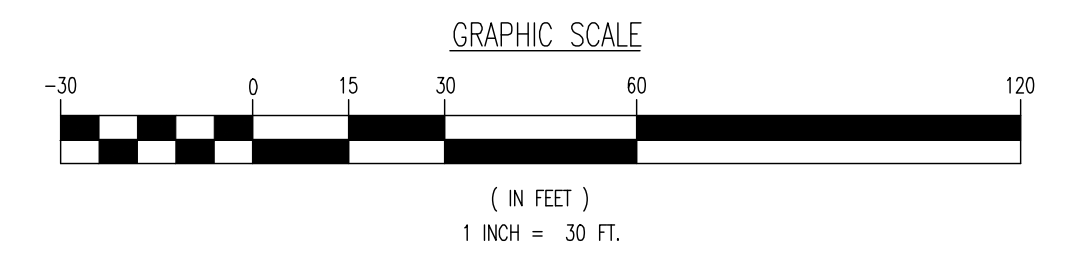

THIS PLAN SET IS FOR PERMITTING PURPOSES ONLY AND MAY NOT BE USED FOR CONSTRUCTION

 LAND DEVELOPMENT CONSULTING • PERMITTING • GEOTECHNICAL • ENVIRONMENTAL • SURVEY • PLANNING & ZONING		1954 Main Street Lake Como, NJ 07719 T: 732.974.0198 F: 732.974.3521 www.dynamiceng.com
TITLE: EROSION AND STORMWATER POLLUTION PREVENTION PLAN C		
PROJECT: IV2 ROCKLAND LOGISTICS, LLC PROPOSED INDUSTRIAL PARK AT 25 OLD MILL ROAD SECTION 55.22 BLOCK 1, LOT 1; SECTION 55.37; BLOCK 1, LOT 31 OLD MILL ROAD AND HEMION ROAD (CR 93) VILLAGE OF SUFFERN, ROCKLAND COUNTY, NEW YORK	JOB No: 3709-99-004	DATE: 05/30/2023
DESIGNED BY: GMC	CHECKED BY: JMS	SCALE: (H) 1"=30' (V)
JOHN A. PALUS JOSHUA M. SEWALD		SHEET No: 4
PROFESSIONAL ENGINEER NEW YORK LICENSE No. 087502	PROFESSIONAL ENGINEER NEW YORK LICENSE No. 097639	811 PROTECT YOURSELF ALL STATES REQUIRE NETWORK OF UTILITY LOCATIONS. IF ANY UTILITY PRESENT TO VERIFY THE SERVICE OFFICE NUMBER, CALL 811. FOR STATE SPECIFIC DIRECT PHONE NUMBERS VISIT: WWW.CALL811.COM

Plotted: 05/30/23 - 1:05 PM, By: gowdrick, Product Ver: 24.2s (LMS Tech)
 File: P:\VEPC PROJECTS\3709 Brookfield Properties\09-004 Suffern NY.Dwg (Exhibits (Misc))\2023-05-30 Temp_SCD\370999004SE3.dwg, ---> 05 EROSION AND STORMWATER POLLUTION PREVENTION PLAN D

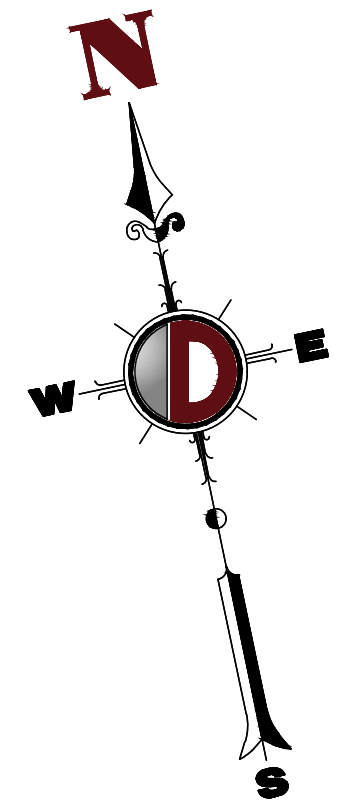
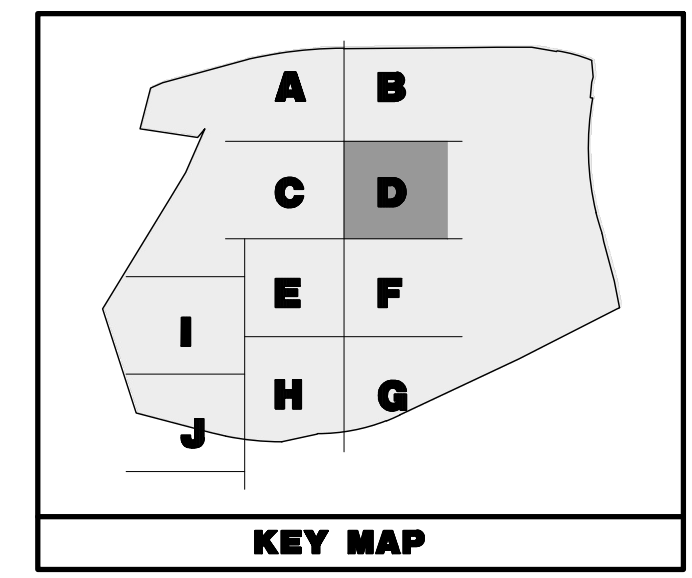
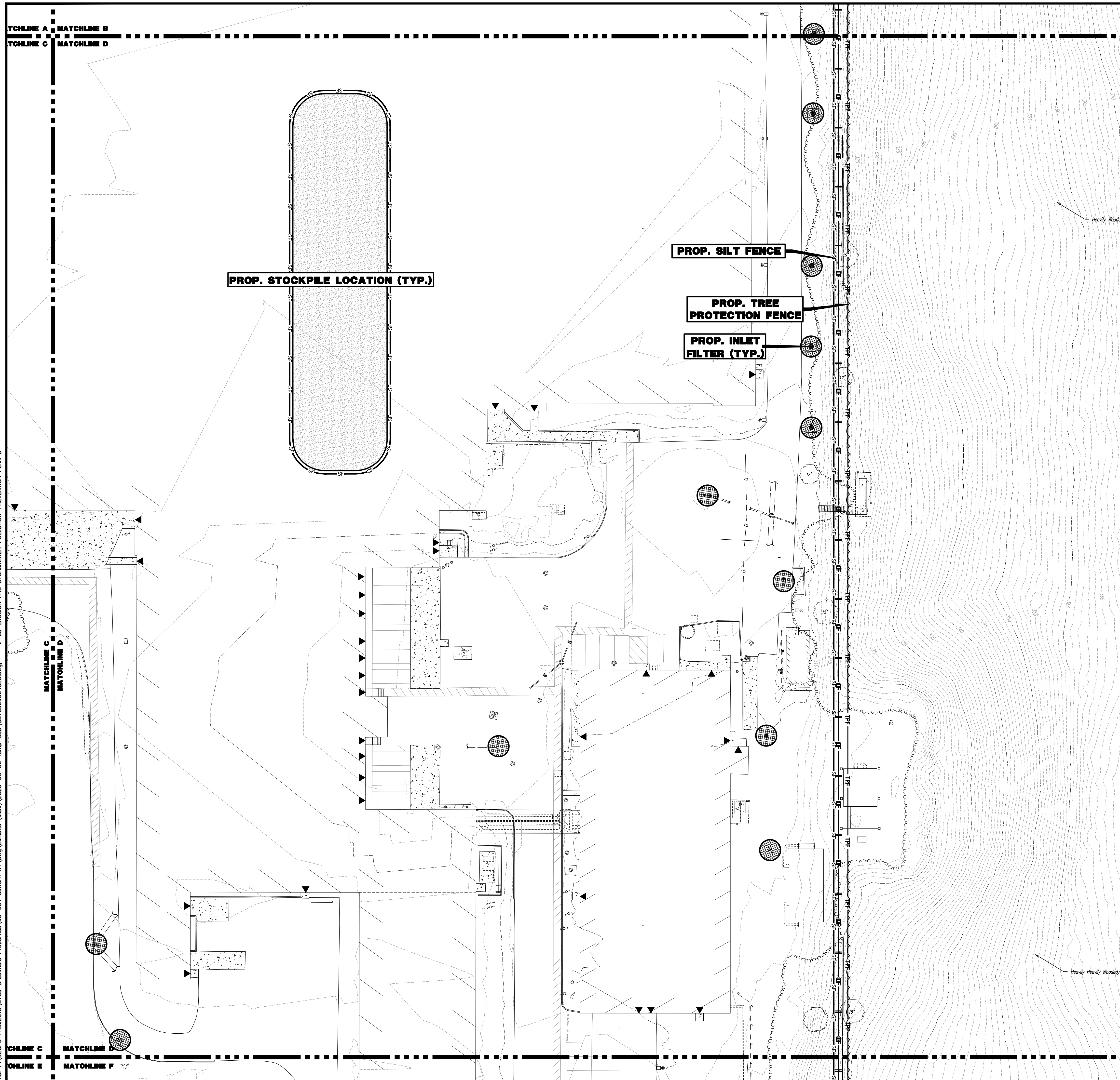

EROSION CONTROL LEGEND

- PROP. SILT FENCE LINE
- PROP. INLET FILTER
- PROP. HAYBALE SEDIMENT BARRIER

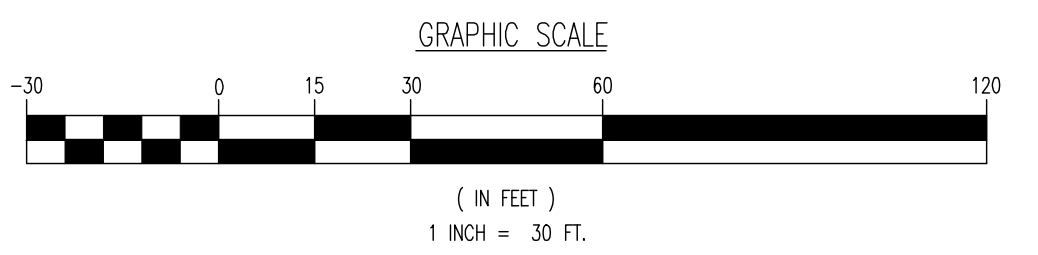

THIS PLAN SET IS FOR PERMITTING PURPOSES ONLY AND MAY NOT BE USED FOR CONSTRUCTION

DYNAMIC ENGINEERING

LAND DEVELOPMENT CONSULTING • PERMITTING • GEOTECHNICAL • ENVIRONMENTAL • SURVEY • PLANNING & ZONING

1964 Main Street, Lake Como, NJ 07719
 T: 732.974.0198 F: 732.974.3521 www.dynamiceng.com

TITLE: EROSION AND STORMWATER POLLUTION PREVENTION PLAN D

PROJECT: IV2 ROCKLAND LOGISTICS, LLC
PROPOSED INDUSTRIAL PARK AT 25 OLD MILL ROAD
 SECTION 55.22 BLOCK 1, LOT 1; SECTION 55.37; BLOCK 1, LOT 31
 OLD MILL ROAD AND HEMION ROAD (CR 93)
 VILLAGE OF SUFFERN, ROCKLAND COUNTY, NEW YORK

JOB No: 3709-99-004 **DATE:** 05/30/2023
DRAWN BY: GMC **SCALE:** (H) 1"=30'
DESIGNED BY: JMS **SHEET No:**
CHECKED BY: JMS **5**
CHECKED BY: -

JOHN A. PALUS **JOSHUA M. SEWALD**
 PROFESSIONAL ENGINEER NEW YORK LICENSE No. 087502
 PROFESSIONAL ENGINEER NEW YORK LICENSE No. 097639

811 PROTECT YOURSELF
 ALL STATES REQUIRE NOTIFICATION OF
 UTILITY LOCATIONS. IF ANY WORK
 IS TO BE DONE, CALL 811 OR VISIT
 811.CALL811.COM

FOR STATE SPECIFIC DIRECT PHONE NUMBERS VISIT:
 WWW.CALL811.COM

Rev. # 0

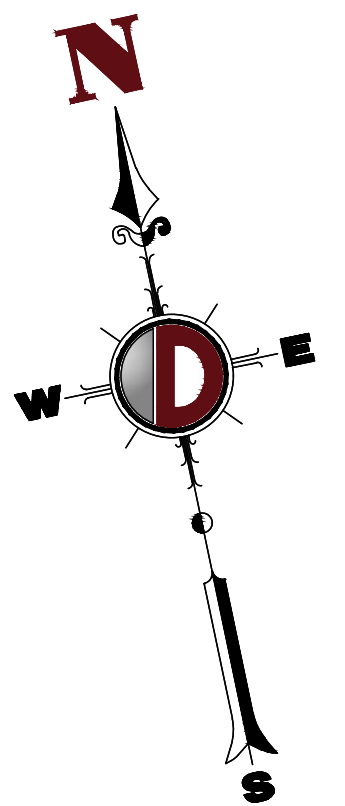
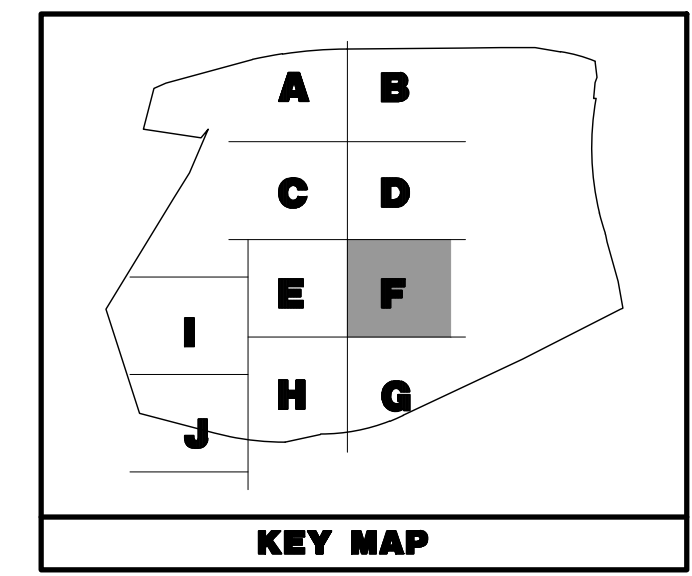
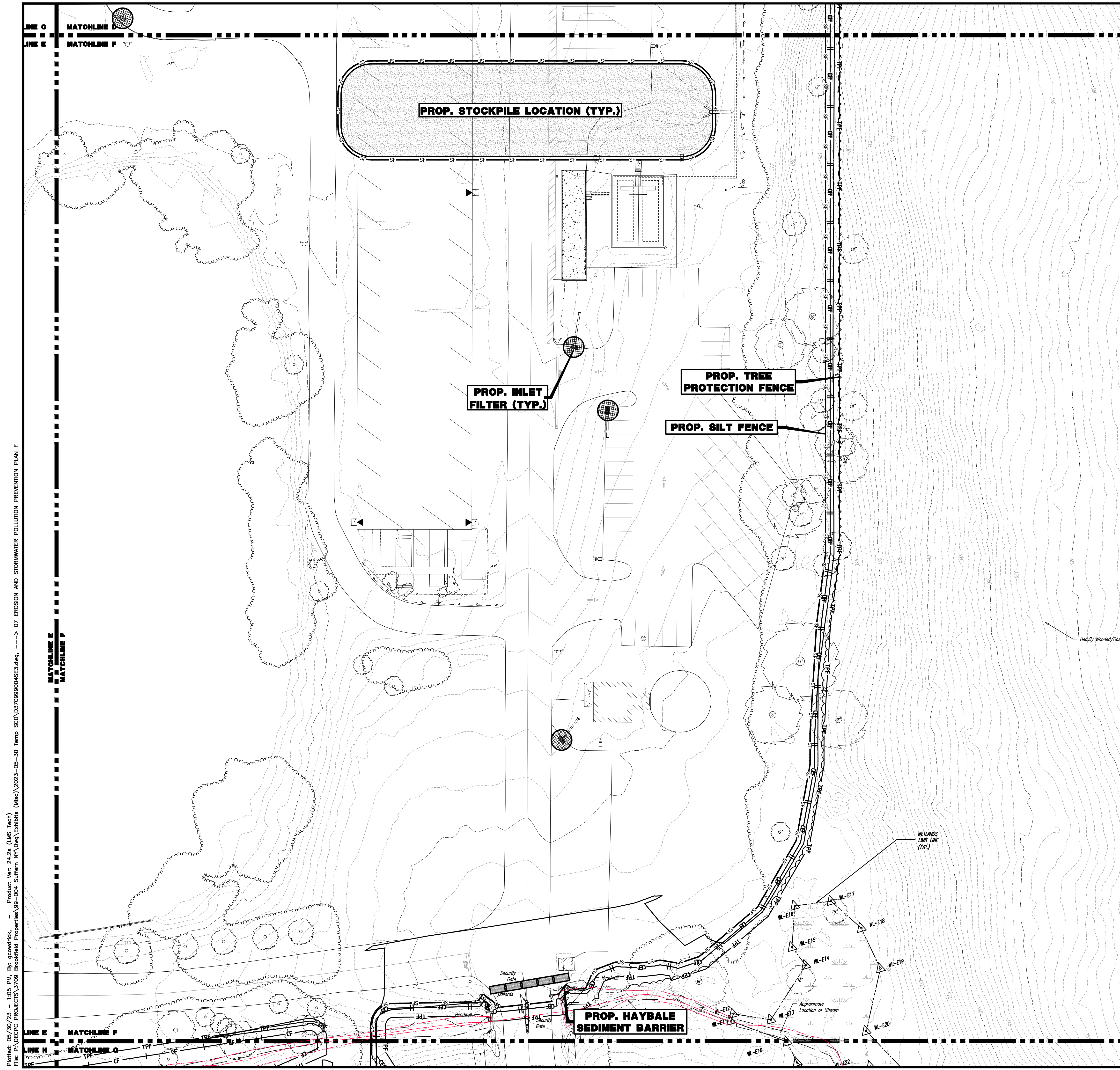

EROSION CONTROL LEGEND

- PROP. SILT FENCE LINE
- PROP. INLET FILTER
- PROP. HAYBALE SEDIMENT BARRIER

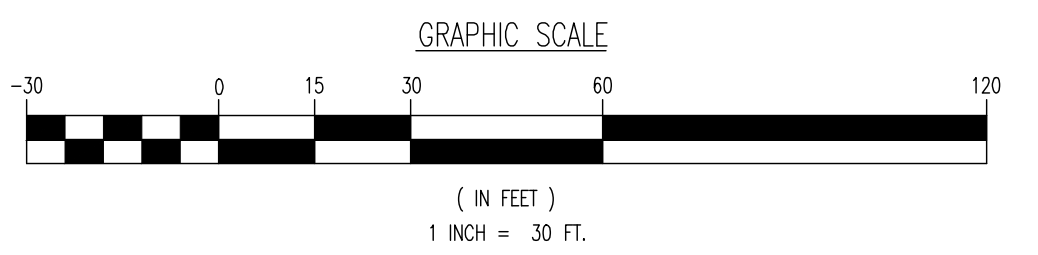

THIS PLAN SET IS FOR PERMITTING PURPOSES ONLY AND MAY NOT BE USED FOR CONSTRUCTION

DYNAMIC ENGINEERING
 LAND DEVELOPMENT CONSULTING • PERMITTING • GEOTECHNICAL • ENVIRONMENTAL • SURVEY • PLANNING & ZONING

1954 Main Street
 Lake Como, NJ 07719
 T: 732.974.0198
 F: 732.974.3521
 www.dynanotec.com

Small office locations listed in other states.

TITLE: **EROSION AND STORMWATER POLLUTION PREVENTION PLAN F**

PROJECT: **IV2 ROCKLAND LOGISTICS, LLC
 PROPOSED INDUSTRIAL PARK AT 25 OLD MILL ROAD
 SECTION 55.22 BLOCK 1, LOT 1; SECTION 55.37; BLOCK 1, LOT 31
 OLD MILL ROAD AND HEMION ROAD (CR 93)
 VILLAGE OF SUFFERN, ROCKLAND COUNTY, NEW YORK**

JOB No: 3709-99-004 DATE: 05/30/2023
 DRAWN BY: GMC SCALE: (H) 1"=30'
 DESIGNED BY: JMS (V)
 CHECKED BY: JMS SHEET No:
 CHECKED BY: -

JOHN A. PALUS **JOSHUA M. SEWALD**

PROFESSIONAL ENGINEER NEW YORK LICENSE No. 087502
 PROFESSIONAL ENGINEER NEW YORK LICENSE No. 097639

811 PROTECT YOURSELF
 ALL UTILITIES REQUIRE NOTIFICATION OF
 EXCAVATION WORK. IF YOU ARE
 PREPARING TO EXCAVATE THE EARTH'S
 SURFACE, CALL 811 FIRST.
 FOR STATE SPECIFIC DIRECT PHONE NUMBERS VISIT:
 WWW.CALL811.COM

Rev. # 0

Plotted: 05/30/23 - 1:05 PM, By: gowardick, Product Ver: 24.2e (LMS Tech)
 File: P:\VEPCP PROJECTS\3709 Brookfield Properties\09-004 Suffern NY.Dwg (Exhibits Misc) 2023-05-30 Temp SCD\370909004SE3.dwg. ---> 07 EROSION AND STORMWATER POLLUTION PREVENTION PLAN F
 COPYRIGHT © 2023 - DYNAMIC ENGINEERING CONSULTANTS, PC - ALL RIGHTS RESERVED

Product: 05/30/23 - 1:05 PM, By: gowardick, Product Ver: 24.2a (IMS Tech)
 File: P:\VEPCP PROJECTS\3709 Brookfield Properties\99-004 Sufferin NY.Dwg (Exhibits Misc) 2023-05-30 Temp_SCD\370909004\SE3.dwg. ---> 08 EROSION AND STORMWATER POLLUTION PREVENTION PLAN G

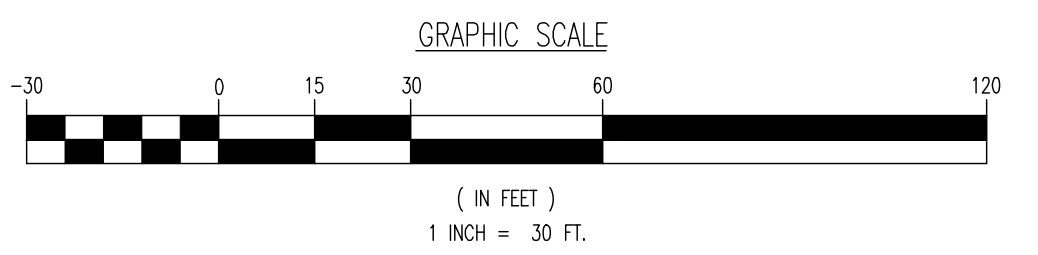
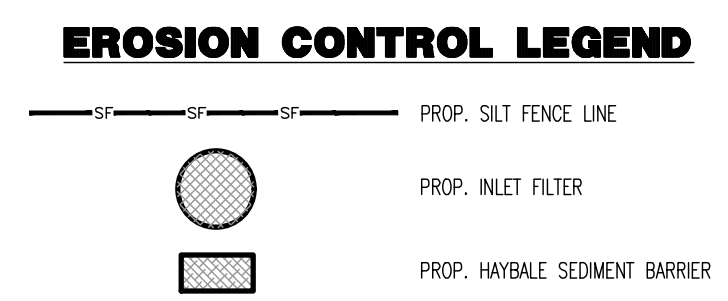
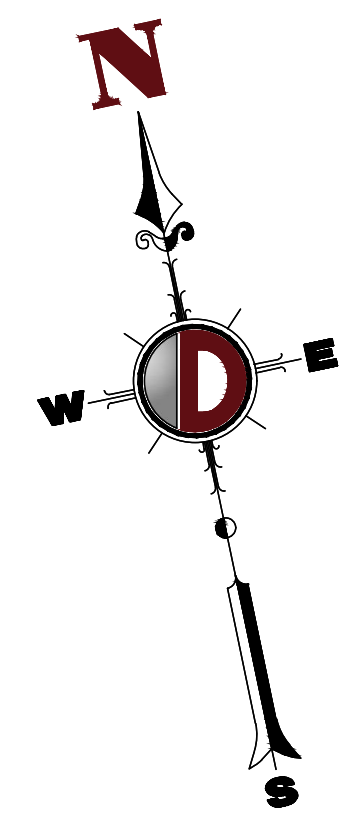
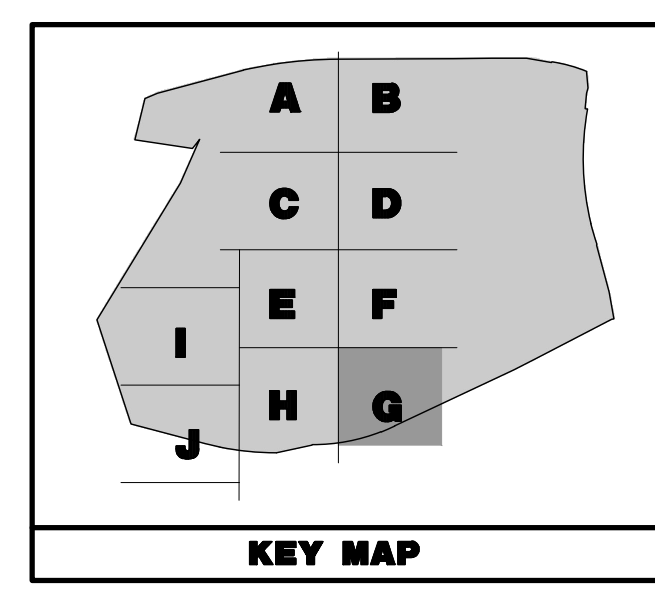
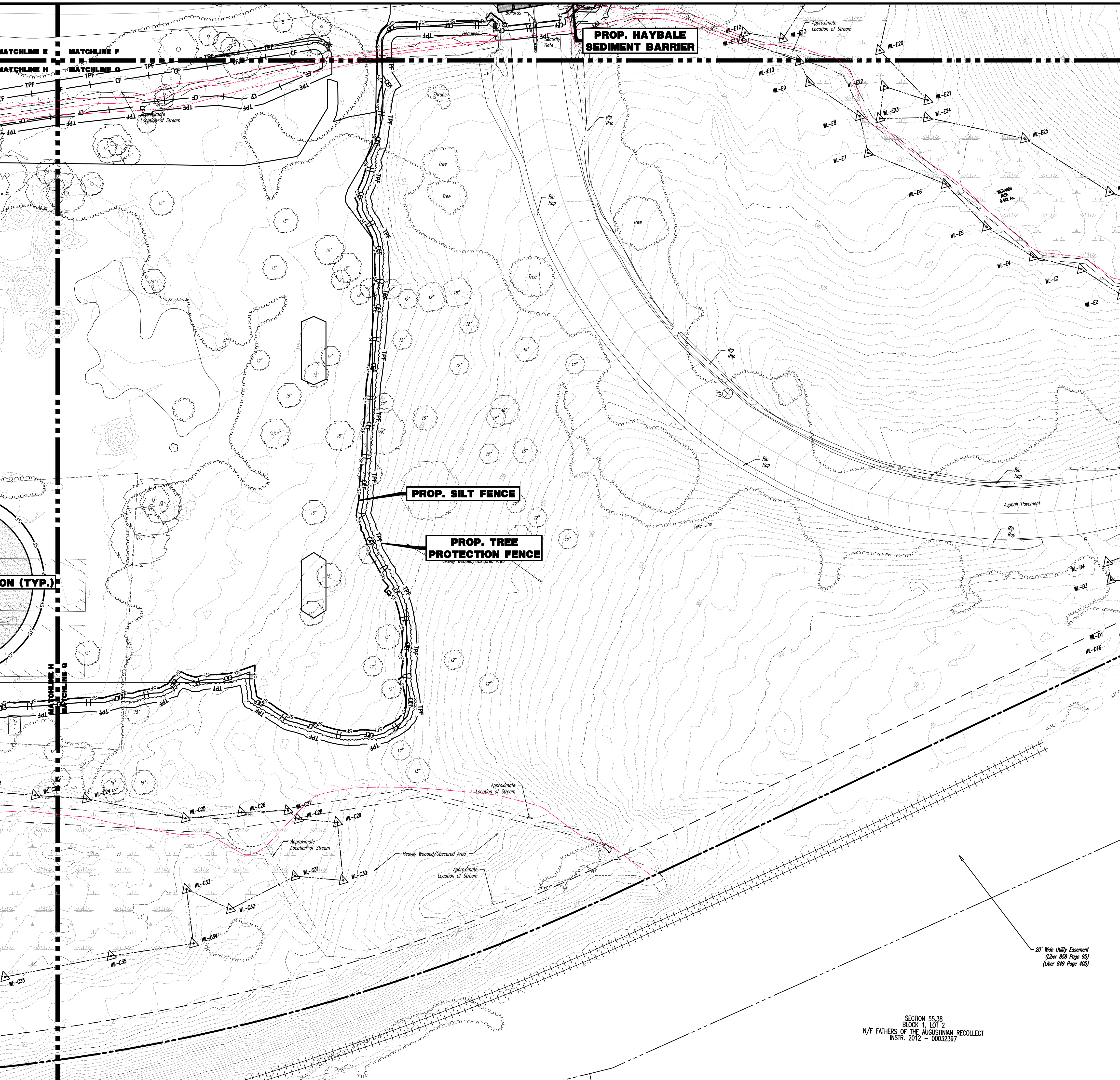

SECTION 55.38
 BLOCK 1, LOT 2
 N/F FATHERS OF THE AUGUSTINIAN RECOLLECT
 INSTR. 2012 - 00032387

20' Wide Utility Easement
 (Libr 856 Page 85)
 (Libr 849 Page 405)

THIS PLAN SET IS FOR PERMITTING PURPOSES ONLY AND MAY NOT BE USED FOR CONSTRUCTION

DYNAMIC ENGINEERING
 LAND DEVELOPMENT CONSULTING • PERMITTING • GEOTECHNICAL • ENVIRONMENTAL • SURVEY • PLANNING & ZONING

1954 Main Street
 Lake Como, NJ 07719
 T: 732.974.0198
 F: 732.974.3521
 www.dynamiceng.com

PROJECT: **IV2 ROCKLAND LOGISTICS, LLC
 PROPOSED INDUSTRIAL PARK AT 25 OLD MILL ROAD**
 SECTION 55.22 BLOCK 1, LOT 1; SECTION 55.37; BLOCK 1, LOT 31
 OLD MILL ROAD AND HEMION ROAD (CR 93)
 VILLAGE OF SUFFERIN, ROCKLAND COUNTY, NEW YORK

JOB No: 3709-99-004
 DATE: 05/30/2023
 DRAWN BY: GMC
 SCALE: (H) 1"=30'
 (V)
 DESIGNED BY: JMS
 SHEET No:
 CHECKED BY: JMS
 CHECKED BY: -

JOHN A. PALUS **JOSHUA M. SEWALD**

PROFESSIONAL ENGINEER
 NEW YORK LICENSE No. 087502

PROFESSIONAL ENGINEER
 NEW YORK LICENSE No. 097639

811 PROTECT YOURSELF
 ALL STATES REQUIRE NOTIFICATION OF
 UTILITY LOCATIONS. IF YOU ARE
 PREPARING TO EXCAVATE OR DIG,
 PLEASE CALL 811 OR VISIT
 811.CALL811.COM
 FOR STATE SPECIFIC DIRECT PHONE NUMBERS VISIT:
 WWW.CALL811.COM

Rev. # 0

Plotted: 05/30/23 - 1:05 PM, By: gowdrick, Product Ver: 24.2a (LMS Tech)
 File: P:\VEPC PROJECTS\3709 Brookfield Properties\3709 Brookfield Properties.dwg, 2023-05-30 Temp_SCD\3709090045E3.dwg, ---> 09 EROSION AND STORMWATER POLLUTION PREVENTION PLAN H

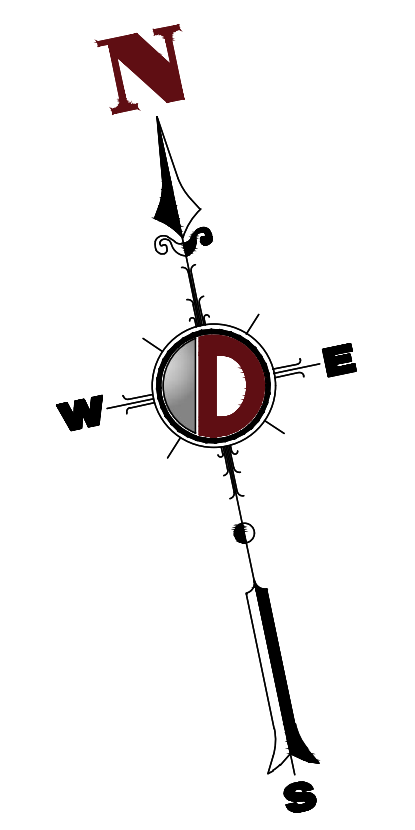
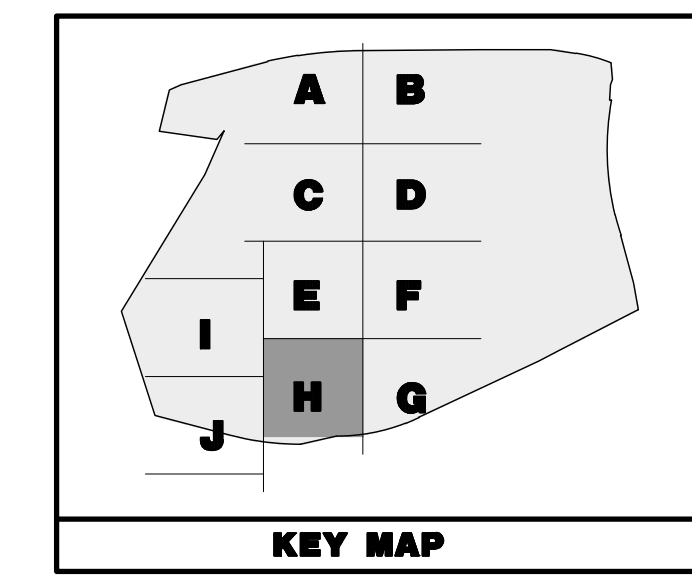
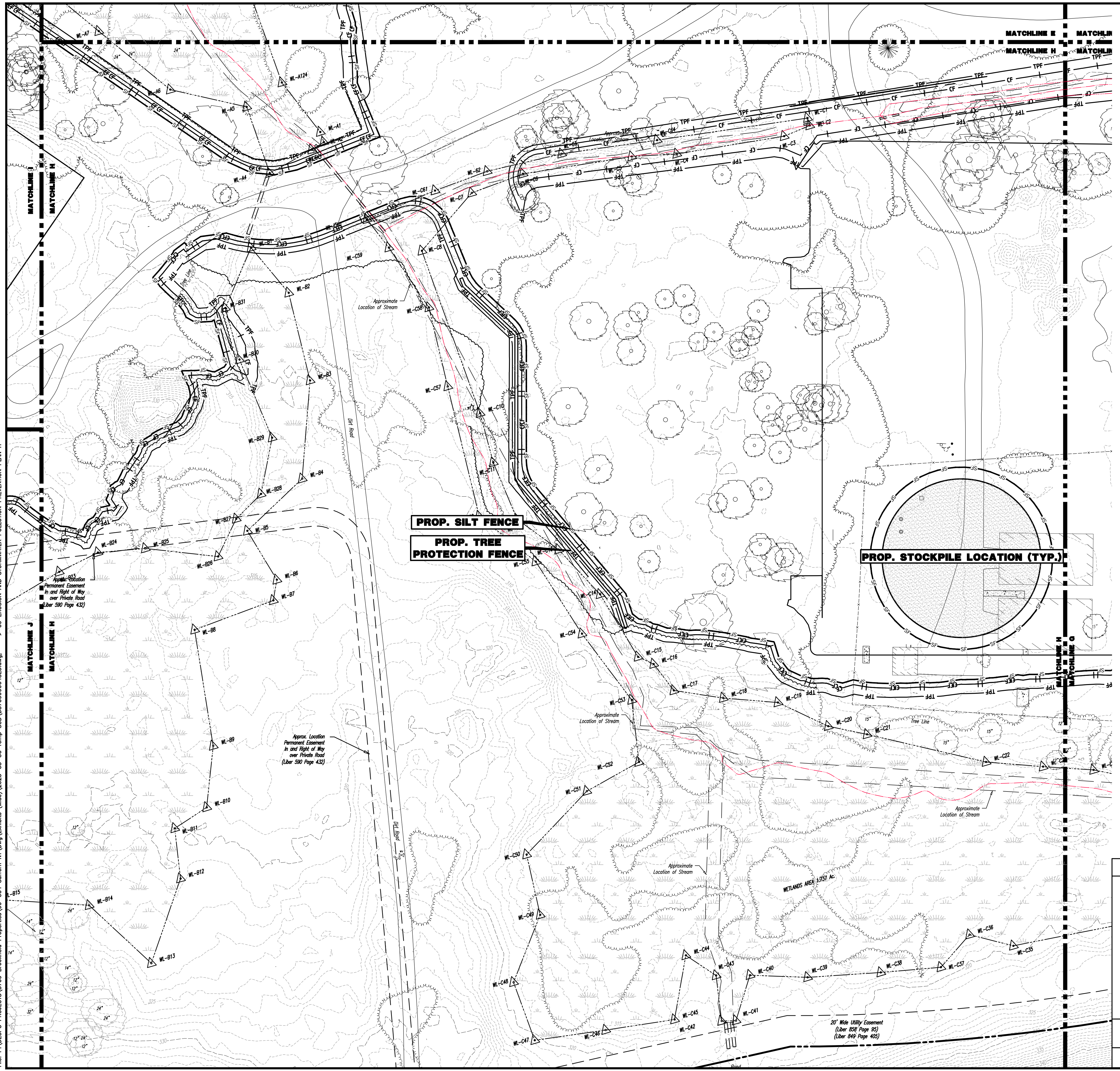

EROSION CONTROL LEGEND

- PROP. SILT FENCE LINE
- PROP. INLET FILTER
- PROP. HAYBALE SEDIMENT BARRIER

PROP. SILT FENCE
PROP. TREE PROTECTION FENCE

PROP. STOCKPILE LOCATION (TYP.)

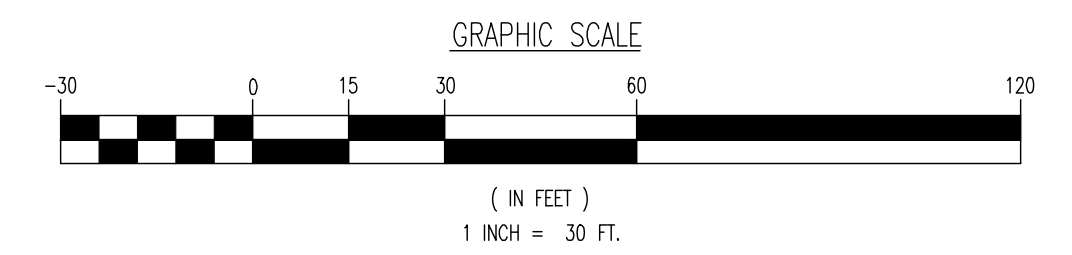

THIS PLAN SET IS FOR PERMITTING PURPOSES ONLY AND MAY NOT BE USED FOR CONSTRUCTION

DYNAMIC ENGINEERING
 LAND DEVELOPMENT CONSULTING • PERMITTING • GEO TECHNICAL • ENVIRONMENTAL • SURVEY • PLANNING & ZONING

1954 Main Street
 Lake Como, NJ 07719
 T: 732.974.0198 F: 732.974.3521
 www.dynamiceng.com

TITLE: **EROSION AND STORMWATER POLLUTION PREVENTION PLAN H**

PROJECT: **IV2 ROCKLAND LOGISTICS, LLC
 PROPOSED INDUSTRIAL PARK AT 25 OLD MILL ROAD**
 SECTION 55.22 BLOCK 1, LOT 1; SECTION 55.37; BLOCK 1, LOT 31
 OLD MILL ROAD AND HEMION ROAD (CR 93)
 VILLAGE OF SUFFERN, ROCKLAND COUNTY, NEW YORK

JOB No: 3709-99-004 DATE: 05/30/2023
 DRAWN BY: GMC SCALE: (H) 1"=30'
 DESIGNED BY: JMS (V)
 CHECKED BY: JMS SHEET No:
 CHECKED BY: JMS

JOHN A. PALUS **JOSHUA M. SEWALD**

PROFESSIONAL ENGINEER NEW YORK LICENSE No. 087502
 PROFESSIONAL ENGINEER NEW YORK LICENSE No. 097639

811 PROTECT YOURSELF
 ALL UTILITIES SHOULD BE LOCATED BY
 EXCAVATION CONTRACTORS OR ANY PERSON
 BEFORE ANY EXCAVATION OR OTHER
 WORK IS BEGUN. CALL 811 OR VISIT
 WWW.CALL811.COM

Rev. # 0

Plotted: 05/30/23 - 1:08 PM, By: gowdrick, Product Ver: 24.2e (LMS Tech)
 File: P:\VEPC PROJECTS\3709 Brookfield Properties\3709 Brookfield Properties.dwg Exhibits (Misc) 2023-05-30 Temp SCD\3709090045E3.dwg. ---> 10 EROSION AND STORMWATER POLLUTION PREVENTION PLAN I

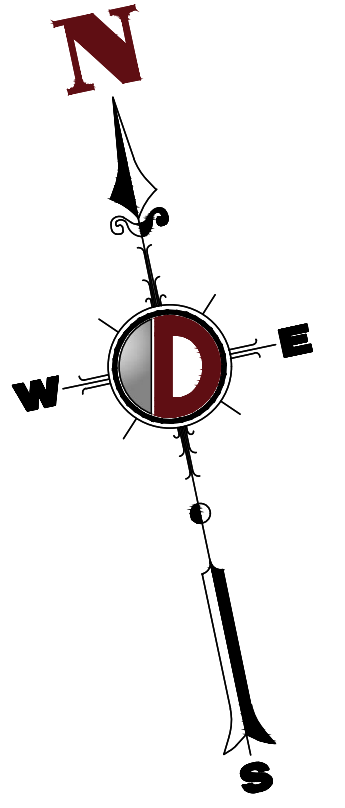
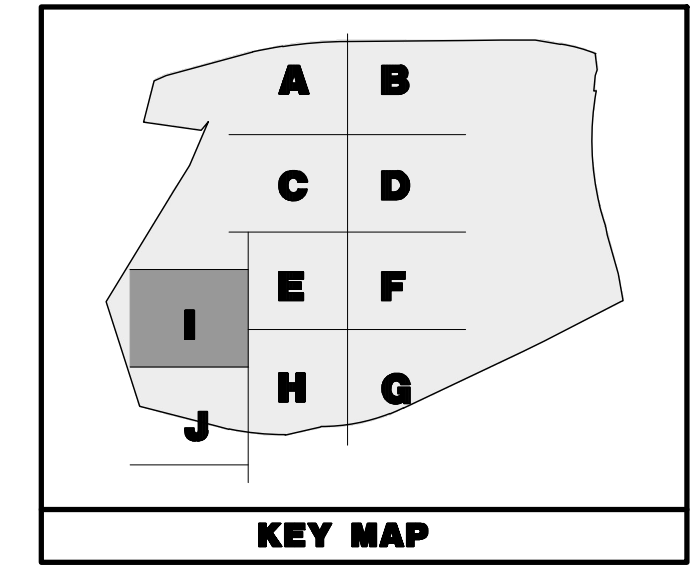
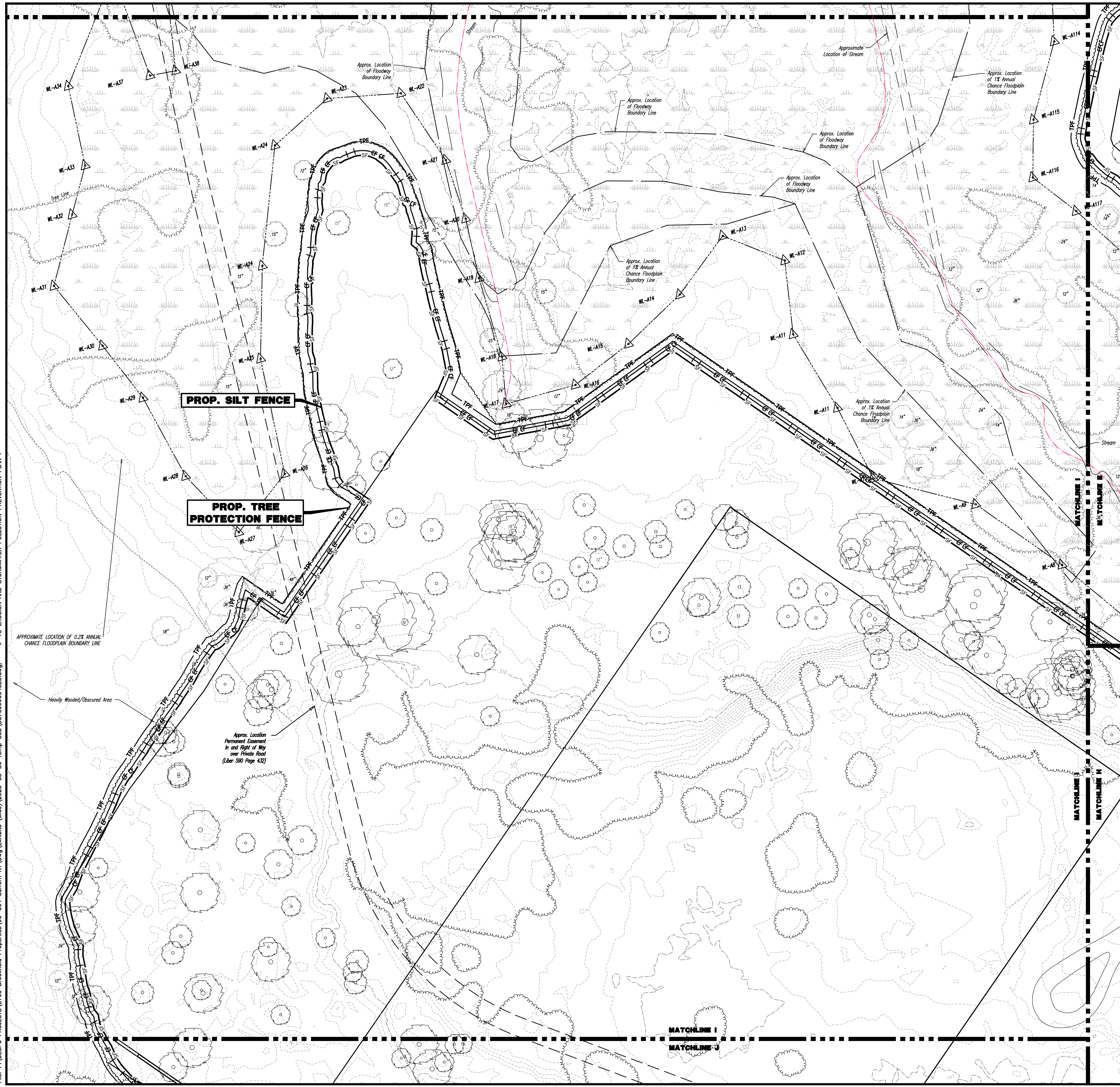

EROSION CONTROL LEGEND

- PROP. SILT FENCE LINE
- PROP. TREE PROTECTION FENCE LINE
- PROP. INLET FILTER
- PROP. HAYBALE SEDIMENT BARRIER

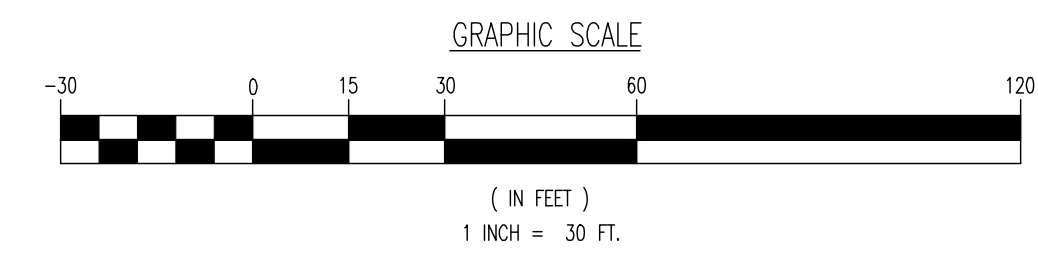

THIS PLAN SET IS FOR PERMITTING PURPOSES ONLY AND MAY NOT BE USED FOR CONSTRUCTION

<p style="font-size: 8px; margin: 0;"> LAND DEVELOPMENT CONSULTING • PERMITTING • GEOTECHNICAL • ENVIRONMENTAL • SURVEY • PLANNING & ZONING Lake Como, New Jersey Chester, New Jersey Newark, New Jersey Torrs River, New Jersey 1934 Main Street Lake Como, NJ 07719 Chester, NJ 08036 Newark, NJ 07102 Torrs River, NJ 07718 T: 732.974.0198 F: 732.974.0198 T: 732.974.0198 F: 732.974.0198 T: 732.974.0198 F: 732.974.0198 F: 732.974.3521 www.dynancon.com </p>	
<p>TITLE: EROSION AND STORMWATER POLLUTION PREVENTION PLAN I</p>	
<p>PROJECT: IV2 ROCKLAND LOGISTICS, LLC PROPOSED INDUSTRIAL PARK AT 25 OLD MILL ROAD SECTION 55.22 BLOCK 1, LOT 1; SECTION 55.37; BLOCK 1, LOT 31 OLD MILL ROAD AND HEMION ROAD (CR 93) VILLAGE OF SUFFERN, ROCKLAND COUNTY, NEW YORK</p>	<p>JOB No: 3709-99-004 DATE: 05/30/2023 DRAWN BY: GMC SCALE: (H) 1"=30' (V) DESIGNED BY: JMS CHECKED BY: JMS SHEET No:</p>
<p>JOHN A. PALUS PROFESSIONAL ENGINEER NEW YORK LICENSE No. 087639</p>	<p>JOSHUA M. SEWALD PROFESSIONAL ENGINEER NEW YORK LICENSE No. 097639</p>
<p>811 PROTECT YOURSELF ALL STATES REQUIRE NOTIFICATION OF UTILITY LOCATIONS. IF YOU ARE PREPARING TO EXCAVE OR DIG, CALL 811 OR VISIT www.call811.com</p>	
<p style="font-size: 24px; font-weight: bold;">10</p> <p>OF 12</p>	

SEDIMENT & SOIL EROSION CONTROL NOTES:

1. ALL SOIL EROSION AND SEDIMENT CONTROL PRACTICES WILL BE INSTALLED IN ACCORDANCE WITH THE STATE STANDARDS FOR SOIL EROSION AND SEDIMENT CONTROL, AND WILL BE INSTALLED IN PROPER SEQUENCE AND MAINTAINED UNTIL PERMANENT PROTECTION IS ESTABLISHED.
2. ANY DISTURBED AREA THAT WILL BE LEFT EXPOSED FOR MORE THAN SEVEN (7) DAYS AND NOT SUBJECT TO CONSTRUCTION TRAFFIC SHALL IMMEDIATELY RECEIVE A TEMPORARY SEEDING. IF THE SEASON PROHIBITS TEMPORARY SEEDING, THE DISTURBED AREA WILL BE MULCHED WITH SALT HAY OR EQUIVALENT AND BE BOUND IN ACCORDANCE WITH THE STATE STANDARDS (I.E. PEG AND TWINE, MULCH NETTING, OR LIQUID MULCH BINDER).
3. IMMEDIATELY FOLLOWING INITIAL DISTURBANCE OR ROUGH GRADING, ALL CRITICAL AREAS SUBJECT TO EROSION WILL RECEIVE A TEMPORARY SEEDING IN COMBINATION WITH STRAW MULCH OR A SUITABLE EQUIVALENT, AT A RATE OF 2 TONS PER ACRE, ACCORDING TO STATE STANDARDS.
4. TEMPORARY BERMS ARE TO BE INSTALLED ON ALL CLEARED ROADWAYS AND EASEMENT AREAS IN ACCORDANCE WITH THE STATE STANDARDS.
5. A SUB-BASE COURSE WILL BE APPLIED IMMEDIATELY FOLLOWING ROUGH GRADING AND INSTALLATION OF IMPROVEMENTS IN ORDER TO STABILIZE DRIVEWAYS AND PARKING AREAS. IN AREAS WHERE NO UTILITIES ARE PRESENT, SUB-BASE WILL BE INSTALLED WITHIN 15 DAYS OF PRELIMINARY GRADING.
6. THE SITE SHALL AT ALL TIMES BE GRADED AND MAINTAINED SUCH THAT ALL STORM WATER RUN-OFF IS DIVERTED TO SOIL EROSION MID SEDIMENT CONTROL FACILITIES.
7. ANY STEEP SLOPES RECEIVING PIPELINE INSTALLATION WILL BE BACK FILLED AND STABILIZED DAILY, AS THE INSTALLATION PROCEEDS (I.E. SLOPES GREATER 3:1).
8. ALL SEDIMENTATION STRUCTURES WILL BE INSPECTED AND MAINTAINED ON A REGULAR BASIS.
9. STOCKPILES ARE NOT TO BE LOCATED WITHIN 50' OF A FLOOD PLAIN, SLOPE, ROADWAY, OR DRAINAGE FACILITY. THE BASE OF ALL STOCKPILES MUST BE PROTECTED BY A HAY BALE BARRIER OR SEDIMENT FENCE.
10. A CRUSHED STONE VEHICLE WHEEL CLEANING BLANKET WILL BE INSTALLED IMMEDIATELY AFTER INITIAL SITE DISTURBANCE AND WILL BE INSTALLED WHEREVER A CONSTRUCTION ACCESS ROAD INTERSECTS ANY PAVED ROADWAY. BLANKET SHALL BE 1-1/2" TO 2" CRUSHED STONE AND AT LEAST 30' X 100', AND MUST BE UNDERLAIN WITH A SUITABLE SYNTHETIC SEDIMENT FILTER FABRIC AND MAINTAINED.
11. MAXIMUM SLIDE SLOPES OF ALL EXPOSED SURFACES SHALL NOT EXCEED 3:1 UNLESS OTHERWISE APPROVED.
12. ANY INDIVIDUAL ACCESS ROADS OR DRIVES MUST BE STABILIZED WITH 2-1/2" CRUSHED STONE PRIOR TO COMMENCEMENT OF CONSTRUCTION IN THAT AREA.
13. PAVED ROADWAYS MUST BE KEPT CLEAN AT ALL TIMES.
14. ALL CATCH BASIN INLETS MUST BE PROTECTED WITH A CRUSHED STONE OR HAY BALE FILTER (SEE DETAIL).
15. CONDUIT OUTLET PROTECTION MUST BE INSTALLED AT ALL REQUIRED OUT FALLS PRIOR TO THE DRAINAGE SYSTEM BECOMING OPERATIONAL.
16. ALL DE-WATERING OPERATIONS MUST DISCHARGE DIRECTLY INTO A SEDIMENT FILTER AREA. THE SEDIMENT FILTER SHALL BE COMPOSED OF A SUITABLE SEDIMENT FILTER FABRIC (SEE DETAIL).
17. PERMANENT VEGETATION TO BE SEED OR SOODED ON ALL EXPOSED AREAS WITHIN TEN (10) DAYS AFTER FINAL GRADING. MULCH TO BE USED AS NECESSARY FOR PROTECTION UNTIL SEEDING IS ESTABLISHED.
18. ALL UNSTABILIZED AREAS TO BE SPRINKLED WITH WATER UNTIL WET AT THE BEGINNING OF EACH DAY TO CONTROL DUST.
19. ANY SOIL HAVING A PH OF 4 OR LESS OR CONTAINING IRON SULFIDES SHALL BE COVERED WITH A MINIMUM OF 12" OF SOIL HAVING A PH OF 5 OR MORE PRIOR TO SEEDBED PREPARATION.
20. AT THE TIME OF SITE PREPARATION FOR PERMANENT VEGETATIVE STABILIZATION, ANY SOIL NOT SUITABLE TO SUPPORT ADEQUATE VEGETATIVE GROUND COVER WILL BE REMOVED OR TREATED IN SUCH A WAY TO PERMANENTLY ADJUST THE SOIL CONDITIONS AND RENDER IT SUITABLE FOR VEGETATIVE GROUND COVER. (IF REMOVAL OR TREATMENT OF THE SOIL WILL NOT PROVIDE SUITABLE CONDITIONS, NON-VEGETATIVE MEANS OF PERMANENT GROUND STABILIZATION WILL HAVE TO BE PROVIDED.)
21. ALL SITE WORK FOR SITE PLANS WILL HAVE TO BE COMPLETED PRIOR TO THE SOIL CONSERVATION DISTRICT ISSUING A REPORT OF COMPLIANCE FOR THE ISSUANCE OF A CERTIFICATE OF OCCUPANCY BY THE MUNICIPALITY.
22. THE APPROVING AUTHORITY MAY REQUEST ADDITIONAL MEASURES TO MINIMIZE ON OR OFF SITE EROSION PROBLEMS DURING CONSTRUCTION AND SHALL BE NOTIFIED IN WRITING 72 HOURS PRIOR TO THE COMMENCEMENT OF ANY LAND DISTURBANCE.
23. ANY CHANGES TO THE CERTIFIED SOIL EROSION MID SEDIMENT CONTROL PLANS WILL REQUIRE THE SUBMISSION OF REVISED SOIL EROSION AND SEDIMENT CONTROL PLANS TO THE DISTRICT FOR RECERTIFICATION. THE REVISED PLANS MUST MEET ALL CURRENT STATE SOIL EROSION AND SEDIMENT CONTROL STANDARDS.

STABILIZATION SPECIFICATIONS - TEMPORARY SEEDING AND MULCHING

- LIME - 90 LBS/1,000 SF GROUND LIMESTONE; FERTILIZER - 11 LBS/1,000 SF; 10-20-10 OR EQUIVALENT WORKED INTO SOIL A MINIMUM OF 4".

- SEEDS:

COOL SEASON: PERENNIAL RYE GRASS 100LBS/ACRE OR OTHER APPROVED SEEDS; PLANT BETWEEN MARCH 1 AND MAY 15 OR BETWEEN AUGUST 15 AND OCTOBER 1.

WARM SEASON: PEARL MILLET AT 20 LBS/AC. OR OTHER APPROVED SEEDS; PLANT BETWEEN MAY 15 AND AUGUST 15.

- MULCH - SALT HAY OR SMALL GRAIN STRAW AT A RATE OF 70 TO 90 LBS/1,000 SF TO BE APPLIED ACCORDING TO THE STATE STANDARDS. MULCH SHALL BE SECURED BY APPROVED METHODS (I.E. PEG AND TWINE, MULCH NETTING, OR LIQUID MULCH BINDER).

STABILIZATION SPECIFICATIONS - PERMANENT SEEDING

- PERMANENT STABILIZATION SPECIFICATIONS: SEEDING

1. PRIOR TO SEEDING, AREA IS TO BE TOPSOILED, FINE GRADED, AND RAKED OF ALL DEBRIS LARGER THAN 1/2" DIAMETER.

2. PRIOR TO SEEDING, CONSULT MANUFACTURER'S RECOMMENDATIONS AND INSTRUCTIONS.

3. SEEDING RATES:

PERENNIAL RYEGRASS	1/2 LB/1,000 SQ FT
KENTUCKY BLUEGRASS	1 LB/1,000 SQ FT
RED FESCUE	1 1/2 LB/1,000 SQ FT
SPREADING TENSUE	1 1/2 LB/1,000 SQ FT
FERTILIZER (20:10:10)	14 LBS/1,000 SQ FT
MULCH	14 LBS/1,000 SQ FT

4. GERMINATION RATES WILL VARY AS TO TIME OF YEAR FOR SOWING. CONTRACTOR TO IRRIGATE SEEDS AREA UNTIL AN ACCEPTABLE STAND OF COVER IS ESTABLISHED BY OWNER.

- PERMANENT STABILIZATION SPECIFICATIONS: MULCHING

A. MULCH MATERIALS TO BE UNROTTED SALT HAY, HAY, OR SMALL GRAIN STRAW AT THE RATE OF 1.5 TO 2 TONS PER ACRE OR 70 TO 90 POUNDS PER 1,000 SQ. FT.

B. SPREAD UNIFORMLY BY HAND OR MECHANICALLY SO THAT APPROXIMATELY 75% TO 95% OF SOIL SURFACE WILL BE COVERED.

C. MULCH ANCHORING TO BE DONE IMMEDIATELY AFTER PLACEMENT BY ONE OF THE FOLLOWING METHODS:

- (1) PEG AND TWINE
- (2) MULCH NETTING
- (3) LIQUID MULCH-BINDERS

MULCH STABILIZATION

A. UNROTTED SMALL-GRAIN STRAW, OR SALT HAY AT 2.0 TO 2.5 TONS PER ACRE IS SPREAD UNIFORMLY AT 90 TO 115 POUNDS PER 1,000 SQUARE FEET AND ANCHORED WITH A MULCH ANCHORING TOOL, LIQUID MULCH BINDERS, OR NETTING THE DOWN. OTHER SUITABLE MATERIALS MAY BE USED IF APPROVED BY THE SOIL CONSERVATION DISTRICT.

B. ASPHALT EMULSION IS RECOMMENDED AT THE RATE OF 600 TO 1,200 GALLONS PER ACRE. THIS IS SUITABLE FOR A LIMITED PERIOD OF TIME WHERE TRAVEL BY PEOPLE, ANIMALS, OR MACHINES IS NOT A PROBLEM.

C. SYNTHETIC OR ORGANIC SOIL STABILIZERS MAYBE USED UNDER SUITABLE CONDITIONS AND IN QUANTITIES AS RECOMMENDED BY THE MANUFACTURER.

D. WOOD-FIBER OR PAPER-FIBER MULCH AT THE RATE OF 1,500 POUNDS PER ACRE (OR ACCORDING TO THE MANUFACTURER'S REQUIREMENTS) MAY BE APPLIED BY A HYDROSEEDER.

E. MULCH NETTING, SUCH AS PAPER JUTE, EXCELSIOR, COTTON, OR PLASTIC, MAYBE USED.

F. MULCH ANCHORING TO BE DONE IMMEDIATELY AFTER PLACEMENT BY ONE OF THE FOLLOWING METHODS:

- (1) PEG AND TWINE
- (2) MULCH NETTING
- (3) LIQUID MULCH-BINDERS

SEQUENCE OF CONSTRUCTION:

PHASE 1: INSTALL STONE ANTI-TRACKING PAD AND OTHER SOIL EROSION AND SEDIMENT CONTROL MEASURES INCLUDING DOWN SLOPE PERMETER HAYBALES, SILT FENCING AND TREE PROTECTION FENCING.

PHASE 2: CLEAR AND ROUGH GRADE FOR NEW BUILDING SITE AND OTHER STRUCTURES REQUIRING EXCAVATION.

PHASE 3: EXCAVATION, CONSTRUCTION, AND STABILIZATION OF DETENTION BASIN(S), EXCAVATE AND INSTALL UNDERGROUND PIPING AND DRAINAGE STRUCTURES.

PHASE 4: EXCAVATE FOR BUILDING FOUNDATION.

PHASE 5: COMPLETE BUILDING CONSTRUCTION.

PHASE 6: EXCAVATE AND INSTALL ON-SITE IMPROVEMENTS INCLUDING CURBING, UNDERGROUND PIPING, AND DRAINAGE STRUCTURES.

PHASE 7: FINAL GRADING ON SITE.

PHASE 8: INSTALL PAVING, CONCRETE, AND FINAL VEGETATION INCLUDING SEEDING AND LANDSCAPING.

PHASE 9: REMOVE SOIL EROSION AND SEDIMENT CONTROL MEASURES INCLUDING DOWN SLOPE PERMETER HAYBALES, SILT FENCING AND TREE PROTECTION FENCING.

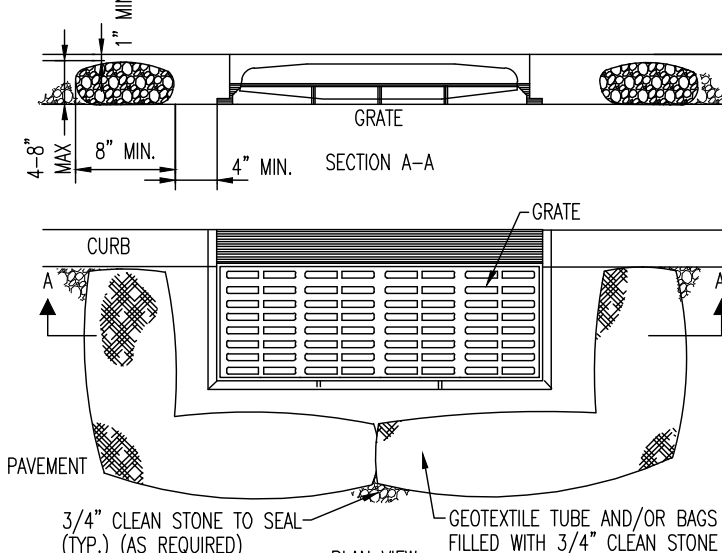

- NOTES:**
1. GEOTEXTILE TO BE WOVEN POLYPROPYLENE PRODUCT 1177, BY SYNTHETIC INDUSTRIES INC., OR TERRATEX SC, BY WETEC INC. OR APPROVED EQUAL.
 2. 3/4" CLEAN STONE CORE SHALL BE COMPLETELY CONTAINED WITHIN GEOTEXTILE. SEAMS SHALL BE SEWN OR CLOSED BY SUITABLE MECHANICAL MEANS TO PREVENT ESCAPE OF STONE.
 3. WHERE NO CURB IS PRESENT, BARRIER SHALL COMPLETELY ENCLOSE THE DRAIN INLET.
 4. INLET GRATE OPENING IS TO BE KEPT CLEAR OF OBSTRUCTIONS AT ALL TIMES.
 5. THE PROTECTION FENCE WILL BE DESIGNED TO CAPTURE OR FILTER RUNOFF FROM THE 1 YEAR, 24 HOUR STORM EVENT AND SHALL SAFELY CONVEY HIGHER FLOWS DIRECTLY INTO THE STORM SEWER SYSTEM.
 6. OTHER METHODS THAT ACCOMPLISH THE PURPOSE OF STORM SEWER INLET PROTECTION MAY BE USED IF APPROVED BY THE SOIL CONSERVATION DISTRICT.
 7. INSPECTIONS SHALL BE FREQUENT, MAINTENANCE, REPAIR AND REPLACEMENT SHALL BE MADE PROMPTLY, AS NEEDED. THE BARRIER SHALL BE REMOVED WHEN THE AREA DRAINING TOWARDS THE INLET HAS BEEN STABILIZED.

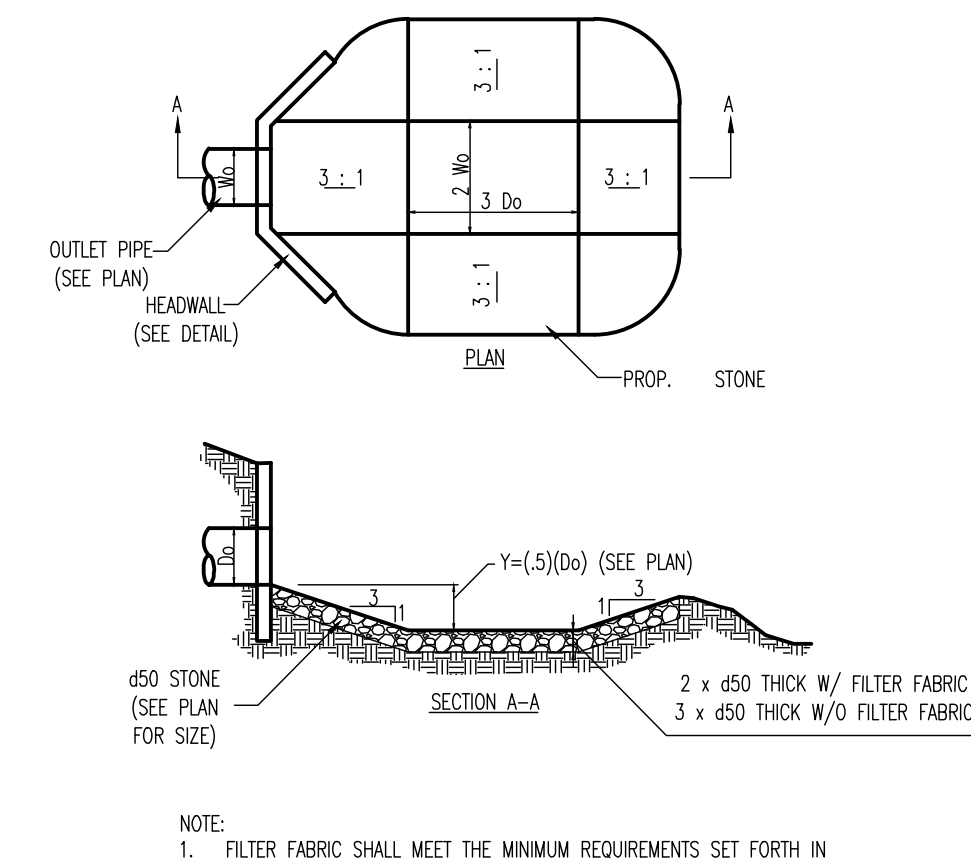

- NOTE:**
1. FILTER FABRIC SHALL MEET THE MINIMUM REQUIREMENTS SET FORTH IN THE STANDARDS FOR SOIL EROSION AND SEDIMENT CONTROL IN NJ.

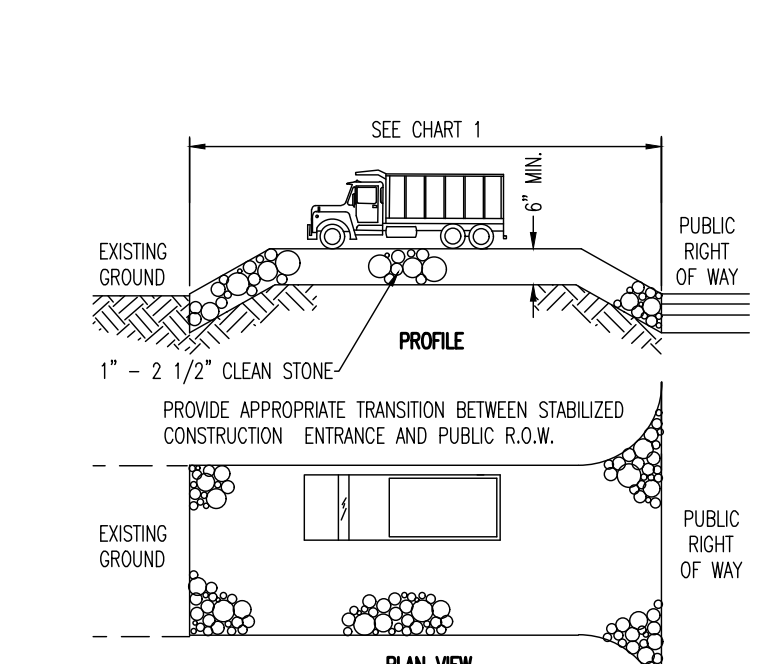
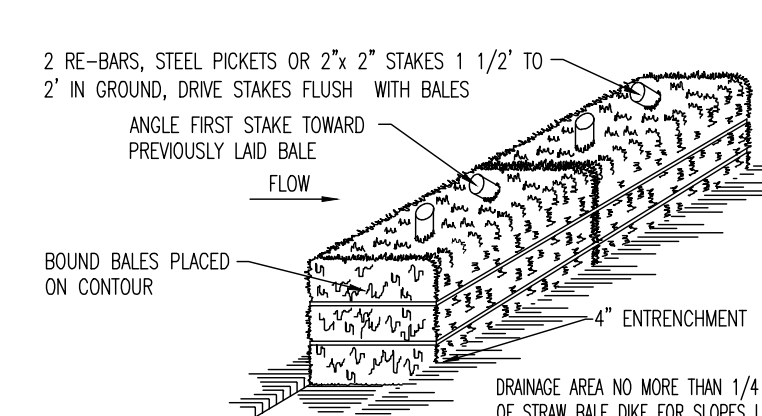

CHART 1

PERCENT SLOPE OF ROADWAY	LENGTH OF STONE REQUIRED
0% TO 2%	COARSE GRAINED SOILS: 50 FT FINE GRAINED SOILS: 100 FT
2% TO 5%	50 FT 200 FT
>5%	ENTIRE ENTRANCE STABILIZED WITH FABR. BASE COURSE (1)

(1) AS PRESCRIBED BY LOCAL ORDINANCE OR OTHER GOVERNING AUTHORITY.



- NOTES:**
1. BALES SHALL BE PLACED AT THE TOP OF A SLOPE OR ON THE CONTOUR AND IN A ROW WITH ENDS TIGHTLY ABUTTING THE ADJACENT BALES.
 2. EACH BALE SHALL BE PLACED SO THE DRIBBLES ARE HORIZONTAL.
 3. BALES SHALL BE SECURELY ANCHORED IN PLACE BY EITHER TWO STAKES OR RE-BARS DRIVEN THROUGH THE BALE. THE FIRST STAKE IN EACH BALE SHALL BE DRIVEN TOWARD THE PREVIOUSLY LAID BALE AT AN ANGLE TO FORCE THE BALES TOGETHER. STAKES SHALL BE DRIVEN FLUSH WITH THE BALE.
 4. INSPECTION SHALL BE FREQUENT AND REPAIR REPLACEMENT SHALL BE PROMPTLY AS NEEDED.
 5. BALES SHALL BE REMOVED WHEN THEY HAVE SEVERED THEIR USEFULNESS SO AS NOT TO BLOCK OR IMPED STORM FLOW OR DRAINAGE.

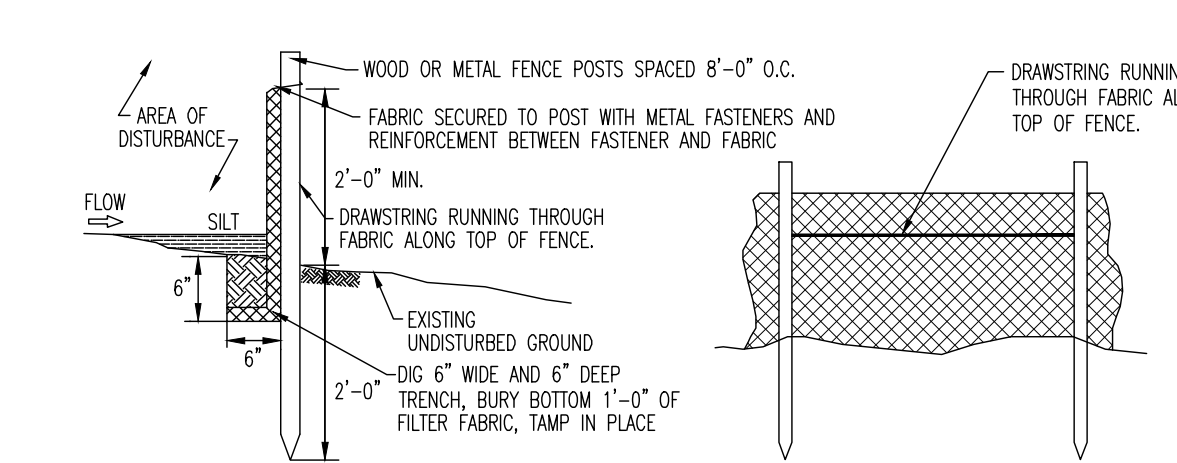

1. PLACE SILT FENCE AT LOCATIONS AS SHOWN ON THE SOIL EROSION AND SEDIMENT CONTROL PLAN.
2. THE SLOPE OF THE LAND FOR AT LEAST 30 FEET ADJACENT TO ANY SILT FENCE SHALL NOT EXCEED 5 PERCENT.
3. SILT FENCE SHALL BE INSTALLED SO WATER CANNOT BYPASS THE FENCE AROUND THE SIDES.
4. INSPECTION SHALL BE FREQUENT AND REPAIR OR REPLACEMENT SHALL BE MADE AS PROMPTLY AS POSSIBLE.
5. SILT FENCE SHALL REMAIN IN PLACE FOR THE DURATION OF THE PROJECT UNLESS OTHERWISE INSTRUCTED BY THE TOWNSHIP ENGINEER OR SOIL CONSERVATION DISTRICT.
6. THE BARRIER SHALL BE REMOVED WHEN THE CONTRIBUTING DRAINAGE AREA HAS BEEN STABILIZED SO AS NOT TO BLOCK OR IMPED STORM FLOW OR DRAINAGE.
7. FENCE POSTS SHALL BE SPACED 8 FEET CENTER-TO-CENTER OR CLOSER. THEY SHALL EXTEND AT LEAST 2 FEET INTO THE GROUND AND EXTEND AT LEAST 2 FEET ABOVE GROUND. POSTS SHALL BE CONSTRUCTED OF HARDWOOD A MIN. DIAMETER THICKNESS OF 1 1/2 INCHES.
8. A METAL FENCE WITH 6 INCH OR SMALLER OPENINGS AND AT LEAST 2 FEET HIGH MAY BE UTILIZED, FASTENED TO THE FENCE POSTS, TO PROVIDE REINFORCEMENT AND SUPPORT TO THE GEOTEXTILE FABRIC WHERE SPACE FOR OTHER PRACTICES IS LIMITED AND HEAVY SEDIMENT LOADING IS EXPECTED.
9. A GEOTEXTILE FABRIC, RECOMMENDED FOR SUCH USE BY THE MANUFACTURER, SHALL BE BURIED AT LEAST 6 INCHES DEEP IN THE GROUND. THE FABRIC SHALL EXTEND AT LEAST 2 FEET ABOVE GROUND. FABRIC MUST BE SECURELY FASTENED TO THE POSTS USING A SYSTEM CONSISTING OF METAL FASTENERS (NAILS OR STAPLES) AND HIGH STRENGTH REINFORCEMENT MATERIAL (NYLON WEBBING, CROMMETS, WASHERS ETC.) PLACED BETWEEN THE FASTENER AND THE GEOTEXTILE FABRIC. THE FASTENING SYSTEM SHALL RESIST TEARING AWAY FROM THE POST. THE FABRIC SHALL INCORPORATE A DRAWSTRING IN THE TOP PORTION OF THE FENCE FOR ADDED STRENGTH.

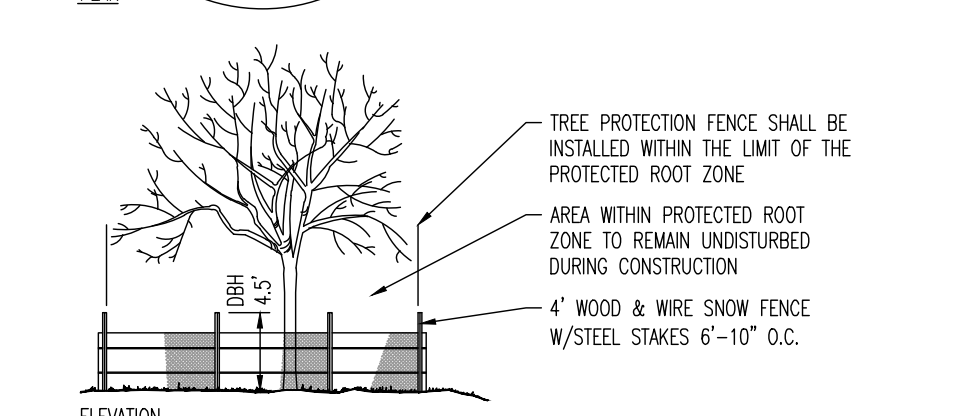
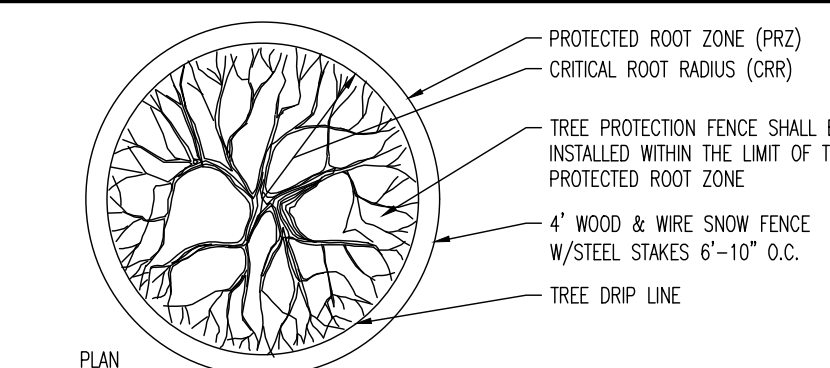
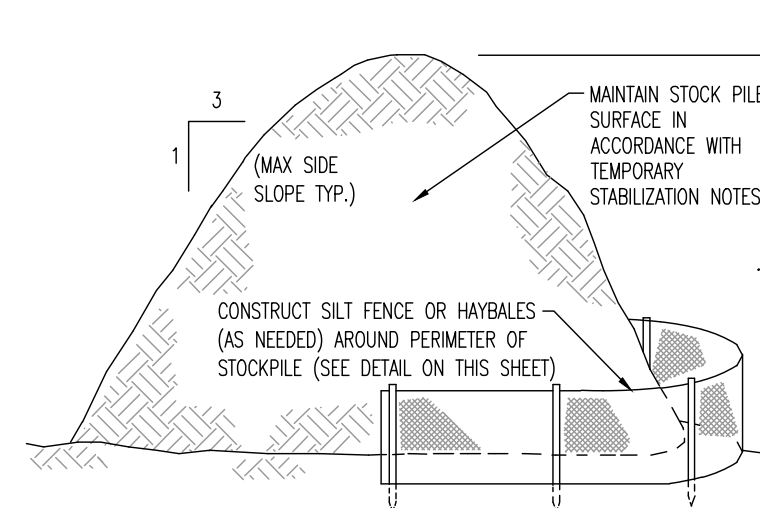

- ESTIMATE A TREE'S PROTECTED ROOT ZONE (PRZ) BY CALCULATING THE CRITICAL ROOT RADIUS (CRR)
1. MEASURE THE DBH (DIAMETER OF TREE AT BREAST HEIGHT, 4.5' ABOVE GROUND ON THE UPHILL SIDE OF TREE) IN INCHES.
 2. MULTIPLY MEASURED DBH BY 1.5 OR 1.0. EXPRESS THE RESULT IN FEET

DBH x 1.5: CRITICAL ROOT RADIUS FOR OLDER, UNHEALTHY, OR SENSITIVE SPECIES.
DBH x 1.0: CRITICAL ROOT RADIUS FOR YOUNGER, HEALTHY OR TOLERANT SPECIES.

Plotted: 05/30/23 - 1:06 PM, By: gowdrick, Product Ver: 24.2e (LMS Tech)
 File: P:\VEPCP PROJECTS\3709 Brookfield Properties\09-004 Suffern NY\DWG\Exhibits (Misc)\2023-05-30 Temp_SCD\370909004SE3.dwg, ---> 12 SOIL EROSION & SEDIMENT NOTES & DETAILS

THIS PLAN SET IS FOR PERMITTING PURPOSES ONLY AND MAY NOT BE USED FOR CONSTRUCTION

DYNAMIC ENGINEERING
LAND DEVELOPMENT CONSULTING • PERMITTING • GEOTECHNICAL • ENVIRONMENTAL • SURVEY • PLANNING & ZONING

1904 Main Street
Lake Como, NJ 07719
T: 732.974.0198
F: 732.974.3521
www.dynamiceng.com

LOKE COMO, NEW JERSEY T: 732.974.0198 | CHARLTER, NEW JERSEY T: 908.879.9229 | HANOVER, NEW JERSEY T: 973.255.7870 | TOWNS RIVER, NEW JERSEY T: 732.478.0200
ALLEN, TEXAS T: 972.234.2100 | ALLEN, TEXAS T: 972.234.2100 | HOUSTON, TEXAS T: 281.789.6400 | DELTA BORO, MISSISSIPPI T: 361.921.8570
NEWBERRY, PENNSYLVANIA T: 267.685.0276 | PHOENIX, PENNSYLVANIA T: 215.233.4888 | SHELLEYSBURG, PENNSYLVANIA T: 610.978.4400

TITLE: **SOIL EROSION & SEDIMENT NOTES & DETAILS**

PROJECT: **IV2 ROCKLAND LOGISTICS, LLC PROPOSED INDUSTRIAL PARK AT 25 OLD MILL ROAD**
SECTION 55.22, BLOCK 1, LOT 1; SECTION 55.37, BLOCK 1, LOT 31
OLD MILL ROAD AND HEMION ROAD (CR 93)
VILLAGE OF SUFFERN, ROCKLAND COUNTY, NEW YORK

JOB No: 3709-99-004
DATE: 05/30/2023
DRAWN BY: GMC
SCALE: (H) NOT TO (V) SCALE
DESIGNED BY: JMS
SHEET No:
CHECKED BY: JMS
CHECKED BY: -

JOHN A. PALUS PROFESSIONAL ENGINEER
NEW YORK LICENSE No. 087502

JOSHUA M. SEWALD PROFESSIONAL ENGINEER
NEW YORK LICENSE No. 097639

811 PROTECT YOURSELF
ALL UTILITIES REQUIRE NOTIFICATION OF EXCAVATION WORKERS. IF ANY UTILITY PREPARING TO EXCAVE THE SITE'S SERVICE AREAS IS NOT NOTIFIED FOR STATE-SPECIFIC DIRECT PHONE NUMBERS VISIT: WWW.CALL811.COM

12
OF 12
Rev. # 0